

NOTICE!!

These documents have been scanned!

Do not place un-scanned documents beneath this notice!

Do not remove this notice from this file!

GPO Jacket No. 560-102
Print Order 61540
Rise Business Services, LLC
Job=AZ15 5/30/2019



Box Number= AZ15104



Claim Begin-End: AMC371816-AMC371819

1 Initial Receipt



AZ15104-10

AMC371533-AMC371978

United States Department of the Interior
 Bureau of Land Management
 BUSINESS & SUPPORT SVCS DIV
 ONE N CENTRAL AVE
 PHOENIX, AZ 85004 -2203
 Phone: (602) 417-9200

ENTERED INTO COMPUTER
 5/15/06 *098*

Receipt

No: 1278585

Transaction #: 1322345	
Date of Transaction: 05/09/2006	
CUSTOMER:	FRANK MOORE 3685 W MAULDING AVE LAS VEGAS,NV 89139

LINE #	QTY	DESCRIPTION	REMARKS	UNIT PRICE	TOTAL
1	4.00	LOCATABLE MINERALS / MINING CLAIMS- NEW,UNADJUD, ONE OR MORE AUTH NOS / NEW MINING CLAIM PROCESSING FEE \$15 (1930) CASES: AMC371816/\$15.00, AMC371817/\$15.00, AMC371818/\$15.00, AMC371819/\$15.00		- n/a -	60.00
2	4.00	LOCATABLE MINERALS / MINING CLAIMS- NEW,UNADJUD, ONE OR MORE AUTH NOS / NEW MINING CLAIM LOCATION FEE \$30 (1993) CASES: AMC371816/\$30.00, AMC371817/\$30.00, AMC371818/\$30.00, AMC371819/\$30.00		- n/a -	120.00
3	4.00	LOCATABLE MINERALS / MINING CLAIMS- NEW,UNADJUD, ONE OR MORE AUTH NOS / NEW MINING CLM MAINT FEE \$125 (1993) CASES: AMC371816/\$125.00, AMC371817/\$125.00, AMC371818/\$125.00, AMC371819/\$125.00	MAIN 2006 (4)	- n/a -	500.00
TOTAL:					\$680.00

PAYMENT INFORMATION					
1	AMOUNT:	\$680.00	POSTMARKED:	05/05/2006	
	TYPE:	CHECK	RECEIVED:	05/08/2006	
	CHECK NO:	1329			
	NAME:	MOORE, FRANK J 3685 W MAULDING AVE LAS VEGAS NV 89139			

REMARKS

This receipt was generated by the automated BLM Collections and Billing System and is a paper representation of a portion of the official electronic record contained therein.

NOTICE!!

These documents have been scanned!

Do not place un-scanned documents beneath this notice!

Do not remove this notice from this file!

GPO Jacket No. 560-102
Print Order 61540
Rise Business Services, LLC
Job=AZ15 5/30/2019



Box Number= AZ15104



Claim Begin-End: AMC371816-AMC371819

2 Correspondence



AZ15104-10

AMC371533-AMC371978

**NO
DOCUMENTS
FOUND**

NO DOCUMENTS FOUND
NO DOCUMENTS FOUND

NOTICE!!

These documents have been scanned!

Do not place un-scanned documents beneath this notice!

Do not remove this notice from this file!

GPO Jacket No. 560-102
Print Order 61540
Rise Business Services, LLC
Job=AZ15 5/30/2019



Box Number= AZ15104



Claim Begin-End: AMC371816-AMC371819

3 Transfers



AZ15104-10

AMC371533-AMC371978

AMC 371876

March 9, 2011

BLM, Arizona State Office
One North Central Ave, Suite 800
Phoenix, AZ 85004-4427

James Miller
P.O. Box 1445
Dolan Springs, AZ 86441

Ref: Quitclaim

Gentleman,

I would like to transfer my interest in 4 mining claims in Mohave County Arizona to another individual.

Transfer to:

Shawn Bender
127 Constitution Ave
Henderson, NV 89015

Association mining claims located May 3, 2006.

HOPPY 1 AMC371816

HOPPY 2 AMC371817

HOPPY 3 AMC371818

HOPPY 4 AMC371819

Enclosed is my check for \$40.00 which I believe is the correct amount. If it is not. Please return this letter to me with a note on the correct amount and I will return it.

Thanks,

James Miller

NO. OF CLAIMS	4
AMOUNT	40.00
RECEIPT NO.	23093203
INIT.	[Signature]

** BLM-ASO **

PHOENIX, AZ

RECEIVED
BLM, AZ STATE OFFICE
2011 MAR 14 A 10:17

ENTERED INTO COMPUTER

3/29/11 AT



FEE# 2011012850

OFFICIAL RECORDS
OF MOHAVE COUNTY
CAROL MEIER,
COUNTY RECORDER



03/08/2011 11:13 AM Fee: \$14.00

PAGE: 1 of 1

RECORDING REQUESTED BY:

James Miller, P.O. Box 1445, Dolan Springs, AZ 86441

AND WHEN RECORDED MAIL TO:

Shawn Bender,
127 Constitution Ave.
Henderson, NV 89015

QUITCLAIM DEED

For the consideration of TEN AND NO/100 DOLLARS, and other valuable considerations, I or we,
JAMES MILLER
hereby Quit-Claim to: Four (4) Mining Claims, recorded as, HOPPY 1 AMC371816, HOPPY 2
AMC371817, HOPPY 3 AMC371818 and HOPPY 4 AMC371819.

To Shawn Bender, a single man
all right, title, or interest in the following described real property situate in MOHAVE County, ARIZONA:

DATED: *Mar 8, 2011*

James Miller
James Miller (claimant)

STATE OF *AZ*)
County of *Mohave*)ss.

On *3-8-2011*, before me, the undersigned Notary Public, personally
appeared *James Miller*, personally
known to me (or proved to me on the basis of satisfactory evidence) to be the person(s) whose name(s)
is/are subscribed to the within instrument and acknowledged to me that he/she/they executed the same
in his/her/their authorized capacity(ies) and that his/her/their signature(s) on the instrument the
person(s) or the entity upon behalf of which the person(s) acted, executed the instrument.

WITNESS my hand and official seal.

My Commission Expires: *10-18-13*

Terri Collana
Notary Public

RECEIVED
B.L.M. AZ STATE OFFICE
2011 MAR 14 A 10:17
PHOENIX, AZ



United States Department of the Interior
Bureau of Land Management
 LANDS/RECREATION & PLANNING
 ONE N CENTRAL AVE
 PHOENIX, AZ 85004 -2203
 Phone:

Receipt

No:

2309323

Transaction #: 2382498	
Date of Transaction: 03/14/2011	
CUSTOMER:	
SHAWN BENDER 127 CONSTITUTION AVE HENDERSON, NV 89015-5776 US	

LINE #	QTY	DESCRIPTION	REMARKS	UNIT PRICE	TOTAL
1	1.00	LOCATABLE MINERALS / MINING CLAIMS-NOT NEW-UNADJUD, ONE AUTH NO. ONLY / MINING CLAIM MONEY RECEIVED CASES: AMC371816/\$40.00	TRF-4	- n/a -	40.00
TOTAL:					\$40.00

PAYMENT INFORMATION					
1	AMOUNT:	40.00	POSTMARKED:	N/A	
	TYPE:	CHECK	RECEIVED:	03/14/2011	
	CHECK NO:	920			
	NAME:	MILLER, JAMES PO BOX 1445 DOLAN SPRINGS AZ 86441 US			

REMARKS

This receipt was generated by the automated BLM Collections and Billing System and is a paper representation of a portion of the official electronic record contained therein.

J. A. Miller
PO Box 1445

Dolan Springs AZ
86445

RECEIVED
BLM AZ STATE OFFICE

2011 MAR 11 P 2:45

PHOENIX, ARIZONA

BLM
Arizona State Office
One North Central Ave. Suite 800
Phoenix AZ 85004-4427

PHOENIX, ARIZONA 85004
MAR 11 2011 PM 3:11

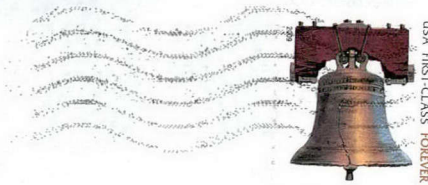

USA FIRST-CLASS FOREVER

85004+4427



NOTICE!!

These documents have been scanned!

Do not place un-scanned documents beneath this notice!

Do not remove this notice from this file!

GPO Jacket No. 560-102
Print Order 61540
Rise Business Services, LLC
Job=AZ15 5/30/2019



Box Number= AZ15104



Claim Begin-End: AMC371816-AMC371819

4 Annual Filings



AZ15104-10

AMC371533-AMC371978

DEPARTMENT OF THE INTERIOR
BUREAU OF LAND MANAGEMENT
MINING CLAIMS

Run Date/Time: 8/21/2019

MC Maintenance Fees Paid Through the BLM Pay Portal
(by Date Paid)

Page 12 Of 184

CBS Receipt: 4533958

Printed For Lead File # AMC371816

Agency Tracking ID: 1565881353

Assessment Year: 2020

Number of BLM Serial Nr: 4

Paid On: 8/15/2019

Total Amount Paid: \$5,280.00

Claim Name	BLM Serial No	Lead File No	Amount Paid
HOPPY 1	AMC371816	AMC371816	\$1,320.00
HOPPY 2	AMC371817	AMC371816	\$1,320.00
HOPPY 3	AMC371818	AMC371816	\$1,320.00
HOPPY 4	AMC371819	AMC371816	\$1,320.00

United States Department of the Interior
Bureau of Land Management
 BUSINESS & SUPPORT SVCS DIV
 ONE N CENTRAL AVE SUITE 800
 PHOENIX, AZ 85004 -4427
 Phone: 602-417-9200

Receipt

No: 4533958

Transaction #: 4654850	
Date of Transaction: 08/15/2019	
CUSTOMER:	
BRANDON JOHNSON 43445 BUSINESS PARK DR TEMECULA, CA 92590 US	

LINE #	QTY	DESCRIPTION	REMARKS	UNIT PRICE	TOTAL
1	1.00	LOCATABLE MINERALS / MINING CLAIMS- NOT NEW-UNADJUD, ONE AUTH NO. ONLY / MINING CLAIM MONEY RECEIVED CASES: AMC371816/\$5280.00		- n/a -	5280.00
TOTAL:					\$5,280.00

PAYMENT INFORMATION			
NOTE: Items will appear on credit card statement as "BLM O Mining Claim".			
1	AMOUNT:	5280.00	POSTMARKED: N/A
	TYPE:	CREDIT CARD	RECEIVED: 08/15/2019
	NAME:	BRANDON JOHNSON 43445 BUSINESS PARK DR TEMECULA CA 92590 US	
	CARD NO:	XXXXXXXXXXXX7326	AUTH CODE: 08671G
	NAME ON CARD:	BRANDON JOHNSON	
	SIGNATURE:	INTERNET	

REMARKS

This receipt was generated by the automated BLM Collections and Billing System and is a paper representation of a portion of the official electronic record contained therein.

DEPARTMENT OF THE INTERIOR
BUREAU OF LAND MANAGEMENT
MINING CLAIMS

Run Date/Time: 9/11/2018

MC Maintenance Fees Paid Through the BLM Pay Portal
(by Date Paid)

Page 225 Of 723

CBS Receipt: 4244227

Printed For Lead File # **AMC371816**

Agency Tracking ID: 1535145197

Assessment Year: 2019

Paid On: 8/24/2018

Number of BLM Serial Nr: 4

Total Amount Paid: \$4,960.00

Claim Name	BLM Serial No	Lead File No	Amount Paid
HOPPY 1	AMC371816	AMC371816	\$1,240.00
HOPPY 2	AMC371817	AMC371816	\$1,240.00
HOPPY 3	AMC371818	AMC371816	\$1,240.00
HOPPY 4	AMC371819	AMC371816	\$1,240.00

United States Department of the Interior

Bureau of Land Management

BUSINESS & SUPPORT SVCS DIV

ONE N CENTRAL AVE SUITE 800

PHOENIX, AZ 85004 -4427

Phone: 602-417-9200

Receipt

No:

4244227

Transaction #: 4359674	
Date of Transaction: 08/24/2018	
CUSTOMER:	
BRANDON R JOHNSON 43445 BUSINESS PARK DR 113 TEMECULA,CA 92590 US	

LINE #	QTY	DESCRIPTION	REMARKS	UNIT PRICE	TOTAL
1	1.00	LOCATABLE MINERALS / MINING CLAIMS- NOT NEW-UNADJUD,ONE AUTH NO. ONLY / MINING CLAIM MONEY RECEIVED CASES: AMC371816/\$4960.00		- n/a -	4960.00
TOTAL:					\$4,960.00

PAYMENT INFORMATION				
NOTE: Items will appear on credit card statement as "BLM O Mining Claim".				
1	AMOUNT:	4960.00	POSTMARKED:	N/A
	TYPE:	CREDIT CARD	RECEIVED:	08/24/2018
	NAME:	BRANDON R JOHNSON 43445 BUSINESS PARK DR 113 TEMECULA CA 92590 US		
	CARD NO:	XXXXXXXXXXXX9939	AUTH CODE:	614241
	NAME ON CARD:	BRANDON R JOHNSON		
	SIGNATURE:			

REMARKS

This receipt was generated by the automated BLM Collections and Billing System and is a paper representation of a portion of the official electronic record contained therein.

Run Date: 08/21/17

Run Time: 09:47 AM

**DEPARTMENT OF THE INTERIOR
BUREAU OF LAND MANAGEMENT
MINING CLAIMS**

MC Maintenance Fees Paid Through the BLM Pay Portal

CBS Receipt: 3936736

Printed For Lead File # AMC371816

Agency Tracking ID: 1502726947

Assessment Year: 2018

Number of BLM Serial Nr: 4

Paid On: 08/14/2017

Total Amount Paid: \$4,960.00

Claim Name	BLM Serial No	Lead File No	Amount Paid
HOPPY 1	AMC371816	AMC371816	\$1,240.00
HOPPY 2	AMC371817	AMC371816	\$1,240.00
HOPPY 3	AMC371818	AMC371816	\$1,240.00
HOPPY 4	AMC371819	AMC371816	\$1,240.00

United States Department of the Interior
Bureau of Land Management
 BUSINESS & SUPPORT SVCS DIV
 ONE N CENTRAL AVE SUITE 800
 PHOENIX, AZ 85004 -4427
 Phone: 602-417-9200

Receipt

No: 3936736

Transaction #: 4046360	
Date of Transaction: 08/14/2017	
CUSTOMER:	
BRANDON R JOHNSON 43445 BUSINESS PARK DR #113 TEMECULA, CA 92590 US	

LINE #	QTY	DESCRIPTION	REMARKS	UNIT PRICE	TOTAL
1	1.00	LOCATABLE MINERALS / MINING CLAIMS- NOT NEW-UNADJUD, ONE AUTH NO. ONLY / MINING CLAIM MONEY RECEIVED CASES: AMC371817/\$4960.00		- n/a -	4960.00
TOTAL:					\$4,960.00

PAYMENT INFORMATION				
NOTE: Items will appear on credit card statement as "BLM O Mining Claim".				
1	AMOUNT:	4960.00	POSTMARKED:	N/A
	TYPE:	CREDIT CARD	RECEIVED:	08/14/2017
	NAME:	BRANDON R JOHNSON 43445 BUSINESS PARK DR #113 TEMECULA CA 92590 US		
	CARD NO:	XXXXXXXXXXXX9939	AUTH CODE:	114190
	NAME ON CARD:	BRANDON R JOHNSON		
	EXPIRES:	03/2020		
	SIGNATURE:			

REMARKS

This receipt was generated by the automated BLM Collections and Billing System and is a paper representation of a portion of the official electronic record contained therein.

Run Date: 08/25/16

Run Time: 05:50 AM

**DEPARTMENT OF THE INTERIOR
BUREAU OF LAND MANAGEMENT
MINING CLAIMS**

MC Maintenance Fees Paid Through the BLM Pay Portal

CBS Receipt: 3631485

Printed For Lead File # **AMC371816**

Agency Tracking ID: 1471285179

Assessment Year: 2017

Number of BLM Serial Nr: 5

Paid On: 08/15/2016

Total Amount Paid: \$5,270.00

Claim Name	BLM Serial No	Lead File No	Amount Paid
OHMI #23	AMC318388	AMC318385	\$310.00
HOPPY 1	AMC371816	AMC371816	\$1,240.00
HOPPY 2	AMC371817	AMC371816	\$1,240.00
HOPPY 3	AMC371818	AMC371816	\$1,240.00
HOPPY 4	AMC371819	AMC371816	\$1,240.00

**United States Department of the Interior
Bureau of Land Management
BUSINESS & SUPPORT SVCS DIV
ONE N CENTRAL AVE SUITE 800
PHOENIX, AZ 85004 -4427
Phone: (602) 417-9200**

Receipt

No: 3631485

Transaction #: 3735284	
Date of Transaction: 08/15/2016	
CUSTOMER:	
BRANDON R JOHNSON 43445 BUSINESS PARK DR #113 TEMECULA, CA 92590 US	

LINE #	QTY	DESCRIPTION	REMARKS	UNIT PRICE	TOTAL
1	1.00	LOCATABLE MINERALS / MINING CLAIMS- NOT NEW-UNADJUD, ONE AUTH NO. ONLY / MINING CLAIM MONEY RECEIVED CASES: AMC371817/\$5270.00		- n/a -	5270.00
TOTAL:					\$5,270.00

PAYMENT INFORMATION			
NOTE: Items will appear on credit card statement as "BLM O Mining Claim".			
1	AMOUNT:	5270.00	POSTMARKED: N/A
	TYPE:	CREDIT CARD	RECEIVED: 08/15/2016
	NAME:	BRANDON R JOHNSON 43445 BUSINESS PARK DR #113 TEMECULA CA 92590 US	
	CARD NO:	XXXXXXXXXXXX9939	AUTH CODE: 315102
	NAME ON CARD:	BRANDON R JOHNSON	
	EXPIRES:	03/2017	
	SIGNATURE:		

REMARKS

This receipt was generated by the automated BLM Collections and Billing System and is a paper representation of a portion of the official electronic record contained therein.

Run Date: 09/08/15

Run Time: 09:20 AM

**DEPARTMENT OF THE INTERIOR
BUREAU OF LAND MANAGEMENT
MINING CLAIMS**

MC Maintenance Fees Paid Through the BLM Pay Portal

CBS Receipt: 3377882

Printed For Lead File # AMC371816

Agency Tracking ID: 1440606951

Number of BLM Serial Nr: 4

Assessment Year: 2016

Paid On: 08/26/2015

Total Amount Paid: \$4,960.00

Claim Name	BLM Serial No	Lead File No	Amount Paid
HOPPY 1	AMC371816	AMC371816	\$1,240.00
HOPPY 2	AMC371817	AMC371816	\$1,240.00
HOPPY 3	AMC371818	AMC371816	\$1,240.00
HOPPY 4	AMC371819	AMC371816	\$1,240.00

United States Department of the Interior
Bureau of Land Management
 BUSINESS & SUPPORT SVCS DIV
 ONE N CENTRAL AVE SUITE 800
 PHOENIX, AZ 85004 -4427
 Phone: (602) 417-9200

Receipt

No: 3377882

Transaction #: 3476134	
Date of Transaction: 08/26/2015	
CUSTOMER:	
BRANDON R JOHNSON 43445 BUSINESS PARK DR TEMECULA, CA 92590 US	

LINE #	QTY	DESCRIPTION	REMARKS	UNIT PRICE	TOTAL
1	1.00	LOCATABLE MINERALS / MINING CLAIMS- NOT NEW-UNADJUD, ONE AUTH NO. ONLY / MINING CLAIM MONEY RECEIVED CASES: AMC371817/\$4960.00		- n/a -	4960.00
TOTAL:					\$4,960.00

PAYMENT INFORMATION			
NOTE: Items will appear on credit card statement as "BLM O Mining Claim".			
1	AMOUNT:	4960.00	POSTMARKED: N/A
	TYPE:	CREDIT CARD	RECEIVED: 08/26/2015
	NAME:	BRANDON R JOHNSON 43445 BUSINESS PARK DR TEMECULA CA 92590 US	
	CARD NO:	XXXXXXXXXXXX9939	AUTH CODE: 116273
	NAME ON CARD:	BRANDON R JOHNSON	
	EXPIRES:	03/2017	
	SIGNATURE:		

REMARKS

This receipt was generated by the automated BLM Collections and Billing System and is a paper representation of a portion of the official electronic record contained therein.

LEAD CASEFILE NUMBERS
RECEIPT NO. - 3109047

35987	371816
100714	372534
190993	373840
304305	390613
318385	406412
324198	411286
325932	412818
327542	420267
329246	426402
330272	
331449	
332360	
333347	
333387	
333855	
335768	
337776	
338212	
338375	
343903	
344407	
344626	
348177	
348413	
350128	
350309	
353613	
355490	
364805	

**BLM ARIZONA STATE OFFICE
JURISDICTION: ARIZONA**

BLM Arizona State Office
1 North Central Avenue
Phoenix, AZ 85004
Phone: 602-417-9200
Fax: 602-417-9556
<http://www.blm.gov/az/st/en.html>

24 June 2014

COUNTY	TYPE	BLM FEE AMOUNT
La Paz, AZ	Placer Claims	\$ 4,340.00
Maricopa, AZ	Placer Claims	5,115.00
Mohave, AZ	Placer Claims	13,640.00
Pima, AZ	Placer Claims	11,935.00
Pinal, AZ	Placer Claims	1,240.00
Yavapai, AZ	Lode and Placer Claims	28,675.00
TOTAL		\$64,945.00

NO. OF CLAIMS
AMOUNT \$64,945.00
RECEIPT NO. 3109047
INIT. GAJ
** BLM-ASO**

RECEIVED
BLM AZ STATE OFFICE
2014 AUG 21 P 2:12
PHOENIX, ARIZONA

ENTERED
AUG 27 2014
BY: RE

\$1705 refund authorized for
2015 mfs paid on closed
claims AMC 372539 &
AMC 420267. RE w/7/14

PREPARED BY

Leonard Riley
Gold Prospectors Association of America
43445 Business Park Drive, Suite 113
Temecula, CA 92590

WHEN RECORDED MAIL TO:

Gold Prospectors Association of America
43445 Business Park Drive, Suite 113
Temecula, CA 92590

**AFFIDAVIT OF ASSESSMENT WORK FOR MINING CLAIMS
MAINTENANCE FEE PAYMENT IN LIEU OF LABOR**

The maintenance fee for the following PLACER CLAIMS in the County of La Paz, State of Arizona applies for the assessment year 2015:

SERIAL REG NUMBER	CLAIM NAME	ACRES	PAYMENT DUE BLM	BOOK/PAGE NUMBER	LEGAL OR LOC
AMC318388	OHMI #23 Carol Moore, et al., claim owner	30	\$310.00	2009-03352	M 14 T 3 N R 18 W S 34
AMC337776	GORBERT ASSOCIATION Cameron Cook, et al., claim owner	160	\$1,240.00	2012-05663	M 14 T 3 N R 18 W S 26/27/28
AMC338212	GUESS IT HAS Gilbert Binns, et al., claim owner	40	\$310.00	2012-05665	M 14 T 4 N R 18 W S 35
AMC364805	FLAT FOOT Barbara Cooper, et al., claim owner	160	\$1,240.00	2012-05664	M 14 T 4 N R 20 W S 34
AMC412819	CACTUS NEEDLE Sharina Davis, et al., claim owner	160	\$1,240.00	2012-05666	M 14 T 4 N R 18 W S 22

Total amount due to BLM is \$4,340.00

RECEIVED
BLM AZ STATE OFFICE
PHOENIX, ARIZONA
AUG 21 P 2:12

PREPARED BY

Leonard Riley
Gold Prospectors Association of America
43445 Business Park Drive, Suite 113
Temecula, CA 92590

WHEN RECORDED MAIL TO:

Gold Prospectors Association of America
43445 Business Park Drive, Suite 113
Temecula, CA 92590

RECEIVED
BLM AZ STATE OFFICE
2011 AUG 21 P 2:12
PHOENIX, ARIZONA

**AFFIDAVIT OF ASSESSMENT WORK FOR MINING CLAIMS
MAINTENANCE FEE PAYMENT IN LIEU OF LABOR**

The maintenance fee for the following PLACER CLAIMS in the County of Maricopa, State of Arizona applies for the assessment year 2015:

SERIAL REG NUMBER	CLAIM NAME	ACRES	PAYMENT DUE BLM	BOOK/PAGE NUMBER	LEGAL OR LOC
AMC100714	YAHOO #4 Marion Burns, et al., claim owner	20	\$155.00	2012-1089980	M 14 T 7 N R 3 W S 20
AMC324198	KING MINING CLAIM #1 Peter Eastman, et al., claim owner	20	\$155.00	2012-1089981	M 14 T 7 N R 3 W S 29
AMC325932	GOLDEN DREAMS #A Peter Eastman, et al., claim owner	40	\$310.00	2012-1089981	M 14 T 7 N R 3 W S 20
AMC333347	DUMB LUCK Jean Wampler, et al., claim owner	40	\$310.00	2012-1089976	M 14 T 7 R 3 S 29
AMC338375	AZ AU #1 Gold Prospectors, et al., claim owner	20	\$155.00	2012-1089979	M 14 T 7 N R 3 W S 29
AMC338376	AZ AU #2 Gold Prospectors, et al., claim owner	20	\$155.00	2012-1089979	M 14 T 7 N R 3 W S 29

AMC35987	YAHOO #2 Marion Burns, et al., claim owner	20	\$155.00	2012-1089980	M 14 T 7 N R 3 W S 29
AMC390613	GOLD FLATZ 1 Frank Benzsema, et al., claim owner	160	\$1,240.00	2012-057361	M 14 T 4N R 6 W S 21
AMC390614	GOLD FLATZ 2 Frank Benzsema, et al., claim owner	160	\$1,240.00	2012-057361	M 14 T 4N R 6 W S 21
AMC406412	VULTURE BAIT Albert Barton, et al., claim owner	160	\$1,240.00	2012-1089975	M 14 T 4N R 6 W S 21

RECEIVED
 BLM AZ STATE OFFICE
 PHOENIX, ARIZONA
 2012 AUG 23 P 2:12

Total amount due to BLM is \$5,115.00

The following PLACER CLAIMS are located in two counties. The BLM payment information is included in the filing for the County of Yavapai, State of Arizona. The following information is for the benefit of the Recorder of the County of Maricopa, State of Arizona:

SERIAL REG NUMBER	CLAIM NAME	ACRES	PAYMENT DUE BLM	BOOK/PAGE NUMBER	LEGAL OR LOC
AMC348413	ABRACADABRA #1 Thomas Collison, et al., claim owner	160	\$0.00	2012-1089973	M 14 T 8 N R 2 E S 29
AMC348414	ABRACADABRA #2 Greg Bowen, et al., claim owner	160	\$0.00	2012-1089973	M 14 T 8 R 2 E S20
AMC350143	CALAMITY #1 John Butler, et al., claim owner	160	\$0.00	2012-1089973	M 14 T 8 N R 2 E S 16 & 21
AMC350144	CALAMITY #2 Terry Huff, et al., claim owner	133.37	\$0.00	2012-1089973	M 14 T 8 N R 2 E S 16
AMC350310	CALAMITY #8 Bruce Austin, et al., claim owner	106.67	\$0.00	2012-1089982	M 14 T 8 N R 2 E S 9
AMC350311	CALAMITY #9 Bruce Austin, et al., claim owner	115	\$0.00	2012-1089982	M 14 T 8 N R 2 E S 16

PREPARED BY

Leonard Riley
Gold Prospectors Association of America
43445 Business Park Drive, Suite 113
Temecula, CA 92590

WHEN RECORDED MAIL TO:

Gold Prospectors Association of America
43445 Business Park Drive, Suite 113
Temecula, CA 92590

RECEIVED
BLM AZ STATE OFFICE
2011 AUG 21 P 2:12
PHOENIX, ARIZONA

**AFFIDAVIT OF ASSESSMENT WORK FOR MINING CLAIMS
MAINTENANCE FEE PAYMENT IN LIEU OF LABOR**

The maintenance fee for the following PLACER CLAIMS in the County of Mohave, State of Arizona applies for the assessment year 2015:

SERIAL REG NUMBER	CLAIM NAME	ACRES	PAYMENT DUE BLM	BOOK/PAGE NUMBER	LEGAL OR LOC
AMC327542	BAHDE 10 Chris Bahde, et al., claim owner	160	\$1,240.00	2012-057359	M 14 T 29 N R 18 W S 20
AMC329246	BAHDE 11 Clarence Bahde, et al., claim owner	160	\$1,240.00	2012-057359	M 14 T 29 N R 18 W S 20
AMC329247	BAHDE 12 Clarence Bahde, et al., claim owner	160	\$1,240.00	2012-057359	M 14 T 29 N R 18 W S 30
AMC329248	BAHDE 13 Clarence Bahde, et al., claim owner	160	\$1,240.00	2012-057359	M 14 T 29 N R 18 W S 30
AMC329249	BAHDE 14 Clarence Bahde, et al., claim owner	160	\$1,240.00	2012-057358	M 14 T 29 N R 18 W S 30
AMC330272	BAHDE 17 Clarence Bahde, et al., claim owner	160	\$1,240.00	2012-057358	M 14 T 29 N R 18 W S 2
AMC330273	BAHDE 18 Clarence Bahde, et al., claim owner	160	\$1,240.00	2012-057358	M 14 T 29 N R 18 W S 2

AMC371816	HOPPY 1 Shawn Bender, et al., claim owner	160	\$1,240.00	2012-057360	M 14 T 29 N R 18 W S 26
AMC371817	HOPPY 2 Shawn Bender, et al., claim owner	160	\$1,240.00	2012-057360	M 14 T 29 N R 18 W S 26
AMC371818	HOPPY 3 Shawn Bender, et al., claim owner	160	\$1,240.00	2012-057360	M 14 T 29 N R 18 W S 26
AMC371819	HOPPY 4 Shawn Bender, et al., claim owner	160	\$1,240.00	2012-057360	M 14 T 29 N R 18 W S 26

Total amount due to BLM is \$13,640.00

RECEIVED
BLM AZ STATE OFFICE
2014 AUG 21 P 2:12
PHOENIX, ARIZONA

PREPARED BY

Leonard Riley
Gold Prospectors Association of America
43445 Business Park Drive, Suite 113
Temecula, CA 92590

WHEN RECORDED MAIL TO:

Gold Prospectors Association of America
43445 Business Park Drive, Suite 113
Temecula, CA 92590

RECEIVED
BLM AZ STATE OFFICE
2014 AUG 21 P 2:12
PHOENIX, ARIZONA

**AFFIDAVIT OF ASSESSMENT WORK FOR MINING CLAIMS
MAINTENANCE FEE PAYMENT IN LIEU OF LABOR**

The maintenance fee for the following PLACER CLAIMS in the County of Pima, State of Arizona applies for the assessment year 2015:

SERIAL REG NUMBER	CLAIM NAME	ACRES	PAYMENT DUE BLM	BOOK/PAGE NUMBER	LEGAL OR LOC
AMC331449	FRIENDSHIP Doreen Howard, et al., claim owner	160	\$1,240.00	20123320973	M 14 T 19 S R 16 E S 28
AMC332360	R DOUBLE J Beverly Podraza, et al., claim owner	70	\$620.00	20123320970	M 14 T 19 S R 15 E S 25
AMC333387	GOLDEN TATTOO Caroleann Black, et al., claim owner	160	\$1,240.00	20123320971	M 14 T 19 S R 15 E S 26
AMC333855	LUCKY STRIKE Beverly Podraza, et al., claim owner	160	\$1,240.00	20123320967	M 14 T 19 S R 15 E S 26
AMC335768	FANTASTIC Doreen Howard, et al., claim owner	160	\$1,240.00	20123320968	M 14 T 19 S R 15 E S 36
AMC426402	POLARIS Louie Gasca, et al., claim owner	60	\$465.00	20123320969	M 14 T 20 S R 10 E S 32 T 21 S R 10 E S 4 & 5

AMC344407	WANDERING STAR Ed Bonnell, et al., claim owner	160	\$1,240.00	20123320975	M 14 T 21 S R 10 E S 8
AMC344626	LUCKY 13 Alyson Johnson, et al., claim owner	160	\$1,240.00	20123320974	M 21 T 24 N R 9 E S 32
AMC353613	MAYBE, MAYBE NOT Richard Conway, et al., claim owner	160	\$1,240.00	20123320972	M 14 T 19 S R 16 E S 28
AMC353614	WET ROCK Kathy Homan, et al., claim owner	160	\$1,240.00	20123320976	M 14 T 21 S R 10 E S 17
AMC411286	QUAD C Charles Colvin, et al., claim owner	60	\$465.00	None	M 14 T 19 S R 15 E S 23 & 26
AMC420267	HERCULES Louie Gasca, et al., claim owner	58	\$465.00	20123320969	M 14 T 20 S R 10 E S 31

Closed

Total amount due to BLM is \$11,935.00

RECEIVED
BLM AZ STATE OFFICE
2014 AUG 21 P 2:12
PHOENIX, ARIZONA

PREPARED BY

Leonard Riley
Gold Prospectors Association of America
43445 Business Park Drive, Suite 113
Temecula, CA 92590

WHEN RECORDED MAIL TO:

Gold Prospectors Association of America
43445 Business Park Drive, Suite 113
Temecula, CA 92590

PHOENIX, ARIZONA

2014 AUG 21 P 2:13

RECEIVED
BLM AZ STATE OFFICE

**AFFIDAVIT OF ASSESSMENT WORK FOR MINING CLAIMS
MAINTENANCE FEE PAYMENT IN LIEU OF LABOR**

The maintenance fee for the following PLACER CLAIMS in the County of Pinal, State of Arizona applies for the assessment year 2015:

SERIAL REG NUMBER	CLAIM NAME	ACRES	PAYMENT DUE BLM	BOOK/PAGE NUMBER	LEGAL OR LOC
AMC372539	OUTBACK GOLD #4 Jeffrey Arnold, et al., claim owner	160	\$1,240.00	None	M 14 T 1 S R 11 E S 16

Total amount due to BLM is \$1,240.00

closed

PREPARED BY

Leonard Riley
 Gold Prospectors Association of America
 43445 Business Park Drive, Suite 113
 Temecula, CA 92590

WHEN RECORDED MAIL TO:

Gold Prospectors Association of America
 43445 Business Park Drive, Suite 113
 Temecula, CA 92590

RECEIVED
 BLM AZ STATE OFFICE
 2014 AUG 21 P 2:13
 PHOENIX, ARIZONA

**AFFIDAVIT OF ASSESSMENT WORK FOR MINING CLAIMS
 MAINTENANCE FEE PAYMENT IN LIEU OF LABOR**

The maintenance fee for the following LODE CLAIMS in the County of Yavapai, State of Arizona applies for the assessment year 2015:

SERIAL REG NUMBER	CLAIM NAME	ACRES	PAYMENT DUE BLM	BOOK/PAGE NUMBER	LEGAL OR LOC
AMC304305	PICKEM UP I Orlando Carroccia, et al., claim owner	20.66	\$155.00	2012-0064663	M 14 T 10 N R 5 W S 24
AMC304306	PICKEM UP II Orlando Carroccia, et al., claim owner	20.66	\$155.00	2012-0064663	M 14 T 10 N R 5 W S 24
AMC304307	PICKEM UP III Orlando Carroccia, et al., claim owner	20.66	\$155.00	2012-0064663	M 14 T 10 N R 5 W S 24

The maintenance fee for the following PLACER CLAIMS in the County of Yavapai, State of Arizona applies for the assessment year 2014:

SERIAL REG NUMBER	CLAIM NAME	ACRES	PAYMENT DUE BLM	BOOK/PAGE NUMBER	LEGAL OR LOC
AMC190993	LOST DUTCHMAN Doug Edwards, et al., claim owner	120	\$930.00	2012-0064661	M 14 T 10 N R 5 W S 25 & 36
AMC343903	DOUBLE J. J. Jacqueline Lew, et al., claim owner	160	\$1,240.00	2012-0064666	M 14 T 13 N R 1 E S 28
AMC343904	SOLDIER BOY Jacqueline Lew, et al., claim owner	160	\$1,240.00	2012-0064691	M 14 T 13 N R 1 E S 29

AMC348177	PICKEM UP AGAIN Orlando Carroccia, et al., claim owner	40	\$310.00	2012-0064663	M 14 T 10 N R 5 W S 24
AMC348413	ABRACADABRA #1 Thomas Collison, et al., claim owner	160	\$1,240.00	2012-0064689	M 14 T 8 N R 2 E S 29
AMC348414	ABRACADABRA #2 Greg Bowen, et al., claim owner	160	\$1,240.00	2012-0064689	M 14 T 8 N R 2 E S 20
AMC348415	ABRACADABRA #3 John Albanese, et al., claim owner	160	\$1,240.00	2012-0064689	M 14 T 8 N R 2 E S 20
AMC348416	ABRACADABRA #4 Thomas Collison, et al., claim owner	160	\$1,240.00	2012-0064689	M 14 T 8 N R 2 E S 20
AMC350128	ABRACADABRA #5 Terry Huff, et al., claim owner	160	\$1,240.00	2012-0064690	M 14 T 8 N R 2 E S 17
AMC350130	ABRACADABRA #7 Terry Huff, et al., claim owner	160	\$1,240.00	2012-0064692	M 14 T 8 N R 2 E S 18
AMC350140	ABRACADABRA #19 Mary Briggs, et al., claim owner	160	\$1,240.00	2012-0064677	M 14 T 9 N R 20 E S 30
AMC350141	ABRACADABRA #20 John Butler, et al., claim owner	160	\$1,240.00	2012-0064693	M 14 T 9 N R 2 E S 29
AMC350143	CALAMITY #1 John Butler, et al., claim owner	160	\$1,240.00	2012-1089977	M 14 T 8 N R 2 E S 16 & 21
AMC350144	CALAMITY #2 Terry Huff, et al., claim owner	133.37	\$1,085.00	2012-1089988	M 14 T 8 N R 2 E S 16
AMC350310	CALAMITY #8 Bruce Austin, et al., claim owner	106.67	\$930.00	2012-1089982	M 14 T 8 N R 2 E S 9

RECEIVED
 PHOENIX, ARIZONA
 2011 AUG 21 P 2:13

AMC350311	CALAMITY #9 Bruce Austin, et al., claim owner	115	\$930.00	2012-1089982	M 14 T 8 N R 2 E S 16
AMC355490	GOLDEN GOBBLER John Koho, et al., claim owner	41.20	\$465.00	2012-0064688	M 14 T 11 N R 1 E S 23
AMC373840	LITTLE PICKER Paul Clark, et al., claim owner	160	\$1,240.00	2012-0064669	M 14 T 9 N R 5 W S 35
AMC373841	GREEN GREASE William Eason, et al., claim owner	160	\$1,240.00	2012-0064684	M 14 T 9 N R 5 W S 34
AMC373842	CAT CLAW William Eason, et al., claim owner	160	\$1,240.00	2012-0064683	M 14 T 9 N R 5 W S 34
AMC373843	OLY POP Paul Clark, et al., claim owner	160	\$1,240.00	2012-0064662	M 14 T 9 N R 5 W S 34
AMC373844	SARAH P Paul Clark, et al., claim owner	160	\$1,240.00	2012-0064660	M 14 T 9 N R 5 W S 35
AMC373845	DESERT PANNER Charles Dougan, et al., claim owner	160	\$1,240.00	2012-0064685	M 14 T 9 N R 5 W S 35
AMC373846	BAKER INN Charles Dougan, et al., claim owner	160	\$1,240.00	2012-0064665	M 14 T 9 N R 5 W S 35
AMC373847	THE STRUT William Eason, et al., claim owner	160	\$1,240.00	2012-0064674	M 14 T 9 N R 5 W S 34

Total amount due to BLM is \$28,675.00

RECEIVED
 BLM AZ STATE OFFICE
 2011 AUG 21 P 2:13
 PHOENIX, ARIZONA

United States Department of the Interior
Bureau of Land Management
 LANDS/RECREATION & PLANNING
 ONE N CENTRAL AVE
 PHOENIX, AZ 85004 -2203
 Phone: 602-417-9200

Receipt

No: 3109047

Transaction #: 3200735	
Date of Transaction: 08/22/2014	
CUSTOMER:	
GOLD PROSPECTORS ASSOCIATION OF AMERICA 43445 BUSINESS PARK DR STE 113 TEMECULA, CA 92590-3671 US	

LINE #	QTY	DESCRIPTION	REMARKS	UNIT PRICE	TOTAL
1	1.00	LOCATABLE MINERALS / MINING CLAIMS- NOT NEW-UNADJUD, ONE AUTH NO. ONLY / MINING CLAIM MONEY RECEIVED CASES: AMC318388/\$64945.00	MAINT FEE PYMNT 2015	- n/a -	64945.00
TOTAL:					\$64,945.00

PAYMENT INFORMATION					
1	AMOUNT:	64945.00	POSTMARKED:	08/19/2014	
	TYPE:	CHECK	RECEIVED:	08/21/2014	
	CHECK NO:	41565			
	NAME:	GOLD PROSPECTORS ASSOCIATION OF AMERICA 43445 BUSINESS PARK DR STE 113 TEMECULA CA 92590-3671 US			

REMARKS

This receipt was generated by the automated BLM Collections and Billing System and is a paper representation of a portion of the official electronic record contained therein.

RE 10/7/14
\$1705 refund authorized
for 2015 maint. fees pd. on
closed claims AMC 420267
AMC 372539. 8/22/14

LEAD CASE FILES for Receipt No. 2856913
filed by GOLD PROSPECTOR ASSN OF AMERICA
August 15, 2013

8385
337776
338212
364805
412818
100714
324198
325932
333347
338375
35987
390613
406412
348413
350128
350309
327542
329246
330272
371816

AMC #s
331449
332360
333387
333855
335768
342810
344407
344626
353613
411286
420267
372534
304305
190993
343903
348177
~~348113~~
355490
373840

RECORDING REQUESTED BY

Claims Department

WHEN RECORDED MAIL TO:

Gold Prospectors Association of America
43445 Business Park Drive, Suite 113
Temecula, CA 92590

RECEIVED
BLM AZ STATE OFFICE
2009 AUG 15 PM 3:03
PHOENIX, ARIZONA

**MAINTENANCE FEE PAYMENT FOR MINING CLAIMS
IN LIEU OF LABOR (ASSESSMENT WORK)**

The maintenance fee for the following PLACER CLAIMS in the County of La Paz, State of Arizona applies for the assessment year 2014:

SERIAL REG NUMBER	CLAIM NAME	ACRES	PAYMENT DUE BLM	BOOK/PAGE NUMBER	LEGAL OR LOC
AMC318388	OHMI #23 Carol Moore, et al., claim owner	30	\$280.00	2009-03352	M 14 T 3 N R 18 W S 34
AMC337776	GORBERT ASSOCIATION Cameron Cook, et al., claim owner	160	\$1,120.00	2012-05663	M 14 T 3 N R 18 W S 26/27/28
AMC338212	GUESS IT HAS Gilbert Binns, et al., claim owner	40	\$280.00	2012-05665	M 14 T 4 N R 18 W S 35
AMC364805	FLAT FOOT Barbara Cooper, et al., claim owner	160	\$1,120.00	2012-05664	M 14 T 4 N R 20 W S 34
AMC412819	CACTUS NEEDLE Sharina Davis, et al., claim owner	160	\$1,120.00	2012-05666	M 14 T 4 N R 13 W S 22

Total amount due to BLM is \$3,920.00

\$3920

I hereby certify under penalty of perjury under the laws of the State of California that the foregoing statements are true and correct.

3942734

ENTERED
AUG 23 2013
BY: RE

2856913

Brandon Johnson, President
Gold Prospectors Association of America
Agent for Claim Owner

43445 Business Park Drive, Suite 113
Temecula, CA 92590
951-699-4749

Executed this 30 day of July, 2013 at Temecula, California.



Brandon Johnson, President
Gold Prospectors Association of America

Date: 7-30-13

State of California
County of Riverside

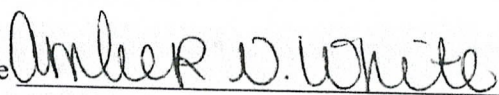
Subscribed and sworn to (or affirmed) before me on this 30th day of July, 2013,
by Brandon Johnson, proved to me on the basis of satisfactory evidence to be the person who appeared
before me.

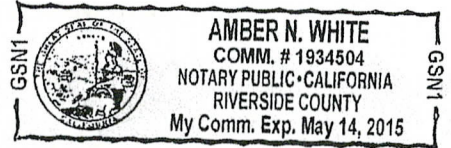
Signature  (Seal)



RECEIVED
NOTARY PUBLIC OFFICE
JUL 30 2013 11:00 AM

RECORDING REQUESTED BY

Claims Department

WHEN RECORDED MAIL TO:

Gold Prospectors Association of America
43445 Business Park Drive, Suite 113
Temecula, CA 92590

RECEIVED
BLM AZ STATE OFFICE
2013 AUG 15 PM 3:04
PHOENIX, ARIZONA

**MAINTENANCE FEE PAYMENT FOR MINING CLAIMS
IN LIEU OF LABOR (ASSESSMENT WORK)**

The maintenance fee for the following PLACER CLAIMS in the County of Maricopa, State of Arizona applies for the assessment year 2014:

SERIAL REG NUMBER	CLAIM NAME	ACRES	PAYMENT DUE BLM	BOOK/PAGE NUMBER	LEGAL OR LOC
AMC100714	YAHOO #4 Marion Burns, et al., claim owner	20	\$140.00	2012-1089980	M 14 T 7 N R 3 W S 20
AMC324198	KING MINING CLAIM #1 Peter Eastman, et al., claim owner	20	\$140.00	2012-1089981	M 14 T 7 N R 3 W S 29
AMC325932	GOLDEN DREAMS #A Peter Eastman, et al., claim owner	40	\$280.00	2012-1089981	M 14 T 7 N R 3 W S 20
AMC333347	DUMB LUCK Jean Wampler, et al., claim owner	40	\$280.00	2012-1089976	M 14 T 7 R 3 S 29
AMC338375	AZ AU #1 Gold Prospectors, et al., claim owner	20	\$140.00	2012-1089979	M 14 T 7 N R 3 W S 29
AMC338376	AZ AU #2 Gold Prospectors, et al., claim owner	20	\$140.00	2012-1089979	M 14 T 7 N R 3 W S 29

\$1120

\$5040

AMC35987	YAHOO #2 Marion Burns, et al., claim owner	20	\$140.00	2012-1089980	M 14 T 7 N R 3 W S 29
AMC390613	GOLD FLATZ 1 Frank Benzsema, et al., claim owner	160	\$1,120.00	2012-057361	M 14 T 4 N R 6 W S 21
AMC390614	GOLD FLATZ 2 Frank Benzsema, et al., claim owner	160	\$1,120.00	2012-057361	M 14 T 4 N R 6 W S 21
AMC406412	VULTURE BAIT Albert Barton, et al., claim owner	160	\$1,120.00	2012-1089975	M 14 T 7 N R 3 W S 21

Total amount due to BLM is \$4,620.00

The following PLACER CLAIMS are located in two counties. The BLM payment information is included in the filing for the County of Yavapai, State of Arizona. The following information is for the benefit of the Recorder of the County of Maricopa, State of Arizona:

SERIAL REG NUMBER	CLAIM NAME	ACRES	PAYMENT DUE BLM	BOOK/PAGE NUMBER	LEGAL OR LOC
AMC348413	ABRACADABRA #1 Thomas Collison, et al., claim owner	160	\$0.00	2012-1089973	M 14 T 8 N R 2 E S 29
AMC348414	ABRACADABRA #2 Greg Bowen, et al., claim owner	160	\$0.00	2012-1089973	M 14 T 8 R 2 E S 20
AMC350143	CALAMITY #1 John Butler, et al., claim owner	160	\$0.00	2012-1089973	M 14 T 8 N R 2 E S 16 & 21
AMC350144	CALAMITY #2 Terry Huff, et al., claim owner	133.37	\$0.00	2012-1089973	M 14 T 8 N R 2 E S 16
AMC350310	CALAMITY #8 Bruce Austin, et al., claim owner	106.67	\$0.00	2012-1089982	M 14 T 8 N R 2 E S 9
AMC350311	CALAMITY #9 Bruce Austin, et al., claim owner	115	\$0.00	2012-1089982	M 14 T 8 N R 2 E S 16

\$3500

\$8540

I hereby certify under penalty of perjury under the laws of the State of California that the foregoing statements are true and correct.

Brandon Johnson, President
Gold Prospectors Association of America
Agent for Claim Owner

43445 Business Park Drive, Suite 113
Temecula, CA 92590
951-699-4749

Executed this 30 day of July, 2013 at Temecula, California.

30

Brandon Johnson, President
Gold Prospectors Association of America

Date: 7-30-13

State of California
County of Riverside

Subscribed and sworn to (or affirmed) before me on this 30 day of July, 2013,
by Brandon Johnson, proved to me on the basis of satisfactory evidence to be the person who appeared
before me.

Signature Amber N. White (Seal)

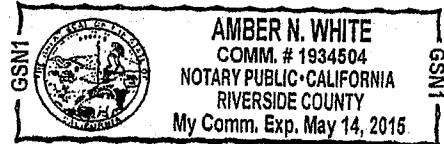

RECEIVED
MAY 15 2015
NOTARY PUBLIC OFFICE

RECORDING REQUESTED BY

Claims Department

WHEN RECORDED MAIL TO:

Gold Prospectors Association of America
43445 Business Park Drive, Suite 113
Temecula, CA 92590

RECEIVED
BLM AZ STATE OFFICE
2ND AND 15TH ST
PHOENIX, ARIZONA

**MAINTENANCE FEE PAYMENT FOR MINING CLAIMS
IN LIEU OF LABOR (ASSESSMENT WORK)**

The maintenance fee for the following PLACER CLAIMS in the County of Mohave, State of Arizona applies for the assessment year 2014:

SERIAL REG NUMBER	CLAIM NAME	ACRES	PAYMENT DUE BLM	BOOK/PAGE NUMBER	LEGAL OR LOC
AMC327542	BAHDE 10 Chris Bahde, et al., claim owner	160	\$1,120.00	2012-057359	M 14 T 29 N R 18 W S 20
AMC329246	BAHDE 11 Clarence Bahde, et al., claim owner	160	\$1,120.00	2012-057359	M 14 T 29 N R 18 W S 20
AMC329247	BAHDE 12 Clarence Bahde, et al., claim owner	160	\$1,120.00	2012-057359	M 14 T 29 N R 18 W S 30
AMC329248	BAHDE 13 Clarence Bahde, et al., claim owner	160	\$1,120.00	2012-057359	M 14 T 29 N R 18 W S 30
AMC329249	BAHDE 14 Clarence Bahde, et al., claim owner	160	\$1,120.00	2012-057358	M 14 T 29 N R 18 W S 30
AMC330272	BAHDE 17 Clarence Bahde, et al., claim owner	160	\$1,120.00	2012-057358	M 14 T 29 N R 18 W S 2
AMC330273	BAHDE 18 Clarence Bahde, et al., claim owner	160	\$1,120.00	2012-057358	M 14 T 29 N R 18 W S 2

\$ 7,840

\$ 16380

AMC371816	HOPPY 1 Shawn Bender, et al., claim owner	160	\$1,120.00	2012-057360	M 14 T 29 N R 18 W S 26
AMC371817	HOPPY 2 Shawn Bender, et al., claim owner	160	\$1,120.00	2012-057360	M 14 T 29 N R 18 W S 26
AMC371818	HOPPY 3 Shawn Bender, et al., claim owner	160	\$1,120.00	2012-057360	M 14 T 29 N R 18 W S 26
AMC371819	HOPPY 4 Shawn Bender, et al., claim owner	160	\$1,120.00	2012-057360	M 14 T 29 N R 18 W S 26

Total amount due to BLM is \$12,320.00

I hereby certify under penalty of perjury under the laws of the State of California that the foregoing statements are true and correct.

Brandon Johnson, President
Gold Prospectors Association of America
Agent for Claim Owner

43445 Business Park Drive, Suite 113
Temecula, CA 92590
951-699-4749

\$ 44,800

\$ 20,860

RECEIVED
BLM
MAY 17 2012

Executed this 30 day of July, 2013 at Temecula, California.

Brandon Johnson
Brandon Johnson, President
Gold Prospectors Association of America

Date: 7-30-13

State of California
County of Riverside

Subscribed and sworn to (or affirmed) before me on this 30 day of JULY, 2013,
by Brandon Johnson, proved to me on the basis of satisfactory evidence to be the person who appeared
before me.

Signature Amber N. White (Seal)

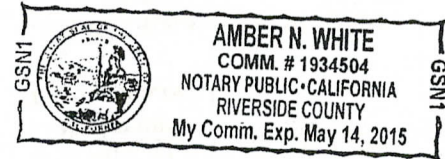

RECEIVED
DIA AD SERVICE OFFICE
2013 AUG 15 PM 3:04
PHOENIX, ARIZONA

RECORDING REQUESTED BY

Claims Department

WHEN RECORDED MAIL TO:

Gold Prospectors Association of America
43445 Business Park Drive, Suite 113
Temecula, CA 92590

RECEIVED
PLACER CLAIMS OFFICE
PIMA COUNTY, ARIZONA
2013 AUG 15 PM 3:04

**MAINTENANCE FEE PAYMENT FOR MINING CLAIMS
IN LIEU OF LABOR (ASSESSMENT WORK)**

The maintenance fee for the following PLACER CLAIMS in the County of Pima, State of Arizona applies for the assessment year 2014:

SERIAL REG NUMBER	CLAIM NAME	ACRES	PAYMENT DUE BLM	BOOK/PAGE NUMBER	LEGAL OR LOC
AMC331449	FRIENDSHIP Doreen Howard, et al., claim owner	160	\$1,120.00	20123320973	M 14 T 19 S R 16 E S 28
AMC332360	R DOUBLE J Beverly Podraza, et al., claim owner	70	\$560.00	20123320970	M 14 T 19 S R 15 E S 25
AMC333387	GOLDEN TATTOO Caroleann Black, et al., claim owner	160	\$1,120.00	20123320971	M 14 T 19 S R 15 E S 26
AMC333855	LUCKY STRIKE Beverly Podraza, et al., claim owner	160	\$1,120.00	20123320967	M 14 T 19 S R 15 E S 26
AMC335768	FANTASTIC Doreen Howard, et al., claim owner	160	\$1,120.00	20123320968	M 14 T 19 S R 15 E S 36
AMC342811	POLARIS Louie Gasca, et al., claim owner	60	\$420.00	20123320969	M 14 T 20 S R 10 E S 32 T 21 S R 10 E S 4 & 5

\$ 5460

\$ 26,320

AMC344407	WANDERING STAR Ed Bonnell, et al., claim owner	160	\$1,120.00	20123320975	M 14 T 21 S R 10 E S 8
AMC344626	LUCKY 13 Alyson Johnson, et al., claim owner	160	\$1,120.00	20123320974	M 21 T 24 N R 9 E S 32
AMC353613	MAYBE, MAYBE NOT Richard Conway, et al., claim owner	160	\$1,120.00	20123320972	M 14 T 19 S R 16 E S 28
AMC353614	WET ROCK Kathy Homan, et al., claim owner	160	\$1,120.00	20123320976	M 14 T 21 S R 10 E S 17
AMC411286	QUAD C Charles Colvin, et al., claim owner	60	\$420.00	None	M 14 T 19 S R 15 E S 23 & 26
AMC420267	HERCULES Louie Gasca, et al., claim owner	58	\$420.00	20123320969	M 14 T 20 S R 10 E S 31

Total amount due to BLM is \$10,780.00

\$5320

I hereby certify under penalty of perjury under the laws of the State of California that the foregoing statements are true and correct.

Brandon Johnson, President
Gold Prospectors Association of America
Agent for Claim Owner

43445 Business Park Drive, Suite 113
Temecula, CA 92590
951-699-4749

RECEIVED
BLM FIELD OFFICE
MAY 15 2014

\$31,640

Executed this 30 day of July, 2013 at Temecula, California.

[Signature]
Brandon Johnson, President
Gold Prospectors Association of America

Date: 7-30-13

State of California
County of Riverside

Subscribed and sworn to (or affirmed) before me on this 30th day of July, 2013,
by Brandon Johnson, proved to me on the basis of satisfactory evidence to be the person who appeared
before me.

Signature Amber N. White (Seal)

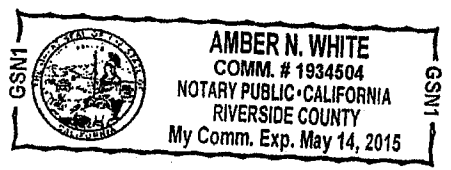

PROCESSED
BY MAIL SERVICE DIVISION
2013 AUG 14 PM 3:01
PHOENIX, ARIZONA

RECORDING REQUESTED BY

Claims Department

WHEN RECORDED MAIL TO:

Gold Prospectors Association of America
43445 Business Park Drive, Suite 113
Temecula, CA 92590

RECEIVED
BLM AZ STATE OFFICE
2013 AUG 15 PM 3:04
PHOENIX, ARIZONA

**MAINTENANCE FEE PAYMENT FOR MINING CLAIMS
IN LIEU OF LABOR (ASSESSMENT WORK)**

The maintenance fee for the following PLACER CLAIMS in the County of Pinal, State of Arizona applies for the assessment year 2014:

SERIAL REG NUMBER	CLAIM NAME	ACRES	PAYMENT DUE BLM	BOOK/PAGE NUMBER	LEGAL OR LOC
AMC372539	OUTBACK GOLD #4 Jeffrey Arnold, et al., claim owner	160	\$1,120.00	None	M 14 T 1 S R 11 E S 16

Total amount due to BLM is \$1,120.00

I hereby certify under penalty of perjury under the laws of the State of California that the foregoing statements are true and correct.

Brandon Johnson, President
Gold Prospectors Association of America
Agent for Claim Owner

43445 Business Park Drive, Suite 113
Temecula, CA 92590
951-699-4749

\$32,760

Executed this 30 day of July, 2013 at Temecula, California.

Brandon Johnson
Brandon Johnson, President
Gold Prospectors Association of America

Date: 7-30-13

State of California
County of Riverside

Subscribed and sworn to (or affirmed) before me on this 30th day of July, 2013,
by Brandon Johnson, proved to me on the basis of satisfactory evidence to be the person who appeared
before me.

Signature Amber N. White (Seal)

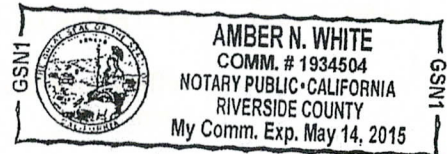

RECEIVED
DLN AZ STATE OFFICE
2013 JUL 15 PM 2:01
PHOENIX, ARIZONA

RECORDING REQUESTED BY

Claims Department

WHEN RECORDED MAIL TO:Gold Prospectors Association of America
43445 Business Park Drive, Suite 113
Temecula, CA 92590RECEIVED
BLM AZ STATE OFFICE
2013 AUG 15 PM 3:05
PHOENIX, ARIZONA**MAINTENANCE FEE PAYMENT FOR MINING CLAIMS
IN LIEU OF LABOR (ASSESSMENT WORK)**

The maintenance fee for the following LODE CLAIMS in the County of Yavapai, State of Arizona applies for the assessment year 2014:

SERIAL REG NUMBER	CLAIM NAME	ACRES	PAYMENT DUE BLM	BOOK/PAGE NUMBER	LEGAL OR LOC
AMC304305	PICKEM UP I Orlando Carroccia, et al., claim owner	20.66	\$140.00	2012-0064663	M 14 T 10 N R 5 W S 24
AMC304306	PICKEM UP II Orlando Carroccia, et al., claim owner	20.66	\$140.00	2012-0064663	M 14 T 10 N R 5 W S 24
AMC304307	PICKEM UP III Orlando Carroccia, et al., claim owner	20.66	\$140.00	2012-0064663	M 14 T 10 N R 5 W S 24

The maintenance fee for the following PLACER CLAIMS in the County of Yavapai, State of Arizona applies for the assessment year 2014:

SERIAL REG NUMBER	CLAIM NAME	ACRES	PAYMENT DUE BLM	BOOK/PAGE NUMBER	LEGAL OR LOC
AMC190993	LOST DUTCHMAN Doug Edwards, et al., claim owner	120	\$840.00	2012-0064661	M 14 T 10 N R 5 W S 25 & 36
AMC343903	DOUBLE J. J. Jacqueline Lew, et al., claim owner	160	\$1,120.00	2012-0064666	M 14 T 13 N R 1 E S 28
AMC343904	SOLDIER BOY Jacqueline Lew, et al., claim owner	160	\$1,120.00	2012-0064691	M 14 T 13 N R 1 E S 29

1 \$3,500

\$36,260

*Don't
Enter*

*Don't
Enter*

AMC348177	PICKEM UP AGAIN Orlando Carroccia, et al., claim owner	40	\$280.00	2012-0064663	M 14 T 10 N R 5 W S 24
AMC348413	ABRACADABRA #1 Thomas Collison, et al., claim owner	160	\$1,120.00	2012-0064689	M 14 T 8 N R 2 E S 29
AMC348414	ABRACADABRA #2 Greg Bowen, et al., claim owner	160	\$1,120.00	2012-0064689	M 14 T 8 N R 2 E S 20
AMC348415	ABRACADABRA #3 John Albanese, et al., claim owner	160	\$1,120.00	2012-0064689	M 14 T 8 N R 2 E S 20
AMC348416	ABRACADABRA #4 Thomas Collison, et al., claim owner	160	\$1,120.00	2012-0064689	M 14 T 8 N R 2 E S 20
AMC350128	ABRACADABRA #5 Terry Huff, et al., claim owner	160	\$1,120.00	2012-0064690	M 14 T 8 N R 2 E S 17
AMC350130	ABRACADABRA #7 Terry Huff, et al., claim owner	160	\$1,120.00	2012-0064692	M 14 T 8 N R 2 E S 18
AMC350140	ABRACADABRA #19 Mary Briggs, et al., claim owner	160	\$1,120.00	2012-0064677	M 14 T 9 N R 20 E S 30
AMC350141	ABRACADABRA #20 John Butler, et al., claim owner	160	\$1,120.00	2012-0064693	M 14 T 9 N R 2 E S 29
AMC350143	CALAMITY #1 John Butler, et al., claim owner	160	\$1,120.00	2012-1089977	M 14 T 8 N R 2 E S 16 & 21
AMC350144	CALAMITY #2 Terry Huff, et al., claim owner	133.37	\$980.00	2012-1089978	M 14 T 8 N R 2 E S 16
AMC350310	CALAMITY #8 Bruce Austin, et al., claim owner	106.67	\$840.00	2012-1089982	M 14 T 8 N R 2 E S 9

RECEIVED
 PLM / STAFF OFFICE
 PHOENIX, ARIZONA

\$2100
 \$10080
 \$12,180

\$48,440

AMC350311	CALAMITY #9 Bruce Austin, et al., claim owner	115	\$840.00	2012-1089982	M 14 T 8 N R 2 E S 16
AMC355490	GOLDEN GOBBLER John Koho, et al., claim owner	41.20	\$420.00	2012-0064688	M 14 T 11 N R 1 E S 23
AMC373840	LITTLE PICKER Paul Clark, et al., claim owner	160	\$1,120.00	2012-0064669	M 14 T 9 N R 5 W S 35
AMC373841	GREEN GREASE William Eason, et al., claim owner	160	\$1,120.00	2012-0064684	M 14 T 9 N R 5 W S 34
AMC373842	CAT CLAW William Eason, et al., claim owner	160	\$1,120.00	2012-0064683	M 14 T 9 N R 5 W S 34
AMC373843	OLY POP Paul Clark, et al., claim owner	160	\$1,120.00	2012-0064662	M 14 T 9 N R 5 W S 34
AMC373844	SARAH P Paul Clark, et al., claim owner	160	\$1,120.00	2012-0064660	M 14 T 9 N R 5 W S 35
AMC373845	DESERT PANNER Charles Dougan, et al., claim owner	160	\$1,120.00	2012-0064685	M 14 T 9 N R 5 W S 35
AMC373846	BAKER INN Charles Dougan, et al., claim owner	160	\$1,120.00	2012-0064665	M 14 T 9 N R 5 W S 35
AMC373847	THE STRUT William Eason, et al., claim owner	160	\$1,120.00	2012-0064674	M 14 T 9 N R 5 W S 34

PHOENIX, ARIZONA
 BLM / AZ STATE OFFICE
 RECEIVED

Total amount due to BLM is \$25,900.00

\$ 8960
 1260
 \$ 10220

I hereby certify under penalty of perjury under the laws of the State of California that the foregoing statements are true and correct.

Brandon Johnson, President
 Gold Prospectors Association of America
 Agent for Claim Owner

43445 Business Park Drive, Suite 113
 Temecula, CA 92590
 951-699-4749

\$58,660

Executed this 30 day of July, 2013 at Temecula, California.

300

Brandon Johnson, President
Gold Prospectors Association of America

Date: 7-30-13

State of California
County of Riverside

Subscribed and sworn to (or affirmed) before me on this 30th day of July, 2013,
by Brandon Johnson, proved to me on the basis of satisfactory evidence to be the person who appeared
before me.

Signature Amber N. White (Seal)

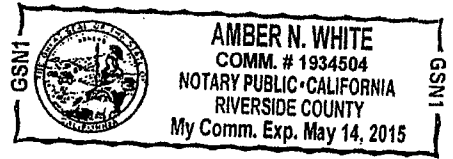

RECEIVED
JUL 30 15 PM 3:07
BRANDON JOHNSON
PRESIDENT, AMERICAN
GOLD PROSPECTORS ASSOCIATION

United States Department of the Interior
 Bureau of Land Management
 LANDS/RECREATION & PLANNING
 ONE N CENTRAL AVE
 PHOENIX, AZ 85004 -2203
 Phone: 602-417-9200

Receipt

No: 2856913

Transaction #: 2942734	
Date of Transaction: 08/16/2013	
CUSTOMER:	
GOLD PROSPECTORS ASSOCIATION OF AMERICA 43445 BUSINESS PARK DR STE 113 TEMECULA, CA 92590-3669 US	

LINE #	QTY	DESCRIPTION	REMARKS	UNIT PRICE	TOTAL
1	1.00	LOCATABLE MINERALS / MINING CLAIMS-NOT NEW-UNADJUD, ONE AUTH NO. ONLY / MINING CLAIM MONEY RECEIVED CASES: AMC318388/\$58660.00	MAINT 2014/419	- n/a -	58660.00
TOTAL:					\$58,660.00

PAYMENT INFORMATION					
1	AMOUNT:	58660.00	POSTMARKED:	08/13/2013	
	TYPE:	CHECK	RECEIVED:	08/15/2013	
	CHECK NO:	40299			
	NAME:	GOLD PROSPECTORS ASSOCIATION OF AMERICA 43445 BUSINESS PARK DR STE 113 TEMECULA CA 92590-3669 US			

REMARKS

This receipt was generated by the automated BLM Collections and Billing System and is a paper representation of a portion of the official electronic record contained therein.

Please use enclosed envelope to mail receipt.

Thank You.

Brittany Wilson

RECEIVED
BIM AZ STATE OFFICE
2012 AUG 14 P 2:00
PHOENIX, ARIZONA



GOLD PROSPECTORS
ASSOCIATION OF AMERICA
P.O. Box 891479 - Temecula, CA 92589-1479
(800) 551-9707 - Fax (951) 699-4062
www.goldprospectors.org

Write special ltr explaining the disbursement of refund & why refunds, i.e. overpayment b/c of acreage discrepancy.

35987
100714
325932
324198
344407
352316
302602
190993
338375
344626
327542
329246
330272
331449
333855
332360
335768
333387
335192
343904
337776
338212
374071
348413
350128
350282
350330
350285
350309
318385
353613
333347
353929
297242
355490
348177
304305
342810
364805
373840
371816
395798
390613
399153
337791
406307
415621
406412

ENTERED IN COMPUTER

RZ 8-23-12

Authorized Date 10/17/2012

Instructions to Accounts AZ BLM REFUND \$1590 TO GOLD PROSPECTORS
ASSOCIATION FOR OVERPAYMENT OF MAINTENANCE FEES
ON AMC350144, AMC406307, AND AMC342810.
RECEIPT#2635544. RE.

Login ID 4105

Entry Date 10/17/2012

Total Amount \$1,590.00

CUSTOMER NAME	RECEIPT NO.	AMOUNT	AMC NO. OR AMC TO AMC	PURPOSE: AMC TO AMC TRANSFERS REFUNDS, ETC. W/justificat'n	MAINT,POL, NOI TRF,AMEND ,ETC.	Date entered in CBS
Charles Byrd	2649723	\$700	AMC394896 AMC396254 AMC396448 AMC396772 AMC396773	Refund- Filed waiver in lieu initial maint. Fee (opt by law)	Maint Fee	Entered- 9/5/2012; Refund- 10/21/12
Timothy Schoder	2622198	\$280	AMC399869 AMC399961	Refund- Filed waiver in lieu initial maint. Fee (opt by law)	Maint Fee	Entered- 8/3/2012; Refund- 10/21/12
Michael Patrick Cone Credit Card	2604898	\$280	AMC371067 AMC390146	Refund- Filed waiver in lieu initial maint. Fee (opt by law)	Maint Fee	Entered- 7/9/2012; Refund- 10/21/12
Jerald D. McKim Credit Card	2634463	\$140	AMC330221	Refund- Filed waiver in lieu initial maint. Fee (opt by law)	Maint Fee	Entered- 8/20/2012; Refund- 10/21/12
Norman Montgomery	2634597	\$1400	AMC414304-309 AMC400019-022	Dupl payment- Maint. Fee	Maint Fee	Entered- 8/15/2012; Refund- 10/21/12
Norman Montgomery	2634609	\$280	AMC414310 AMC414311	Dupl payment- Maint. Fee	Maint Fee	Entered- 8/15/2012; Refund- 10/21/12
Brandon Johnson Credit Card	2631431	\$290	AMC338212 AMC350144(\$90)	Overpayment- Maint. fee	Maint Fee	Entered- 8/15/2012; Refund- 10/21/12
Gold Prospectors Association	2635544	\$1590	AMC406307 AMC342810 AMC350144(\$50)	Overpayment- Maint. fee	Maint Fee	Entered- 8/21/2012; Refund- 10/21/12

Date Requested

October 17, 2012

TRANSFER-REVERSAL REQUESTS

NOTE: if credit card, then put reason in Column 6

\$1120
15

\$49,990 - Receipt 2631431
~~\$49,560~~
\$ 440 overpaid ~~49900~~

11200
5600
16800

17080 \$35,330 Receipt 2635544

11200
2240
13

1400
2800
1120
3920
~~8840~~
17080

Actually Owed : \$49,700
\$32,860
\$82,560

1880

Paid : 49,990
35,330
\$85,320
85,320
82,560
2,760

Overpaid	\$ 200	on	338212
Overpaid	\$ 140	on	350144
Overpaid	\$ 700	on	342810
Overpaid	\$ 840	on	406307
	\$1880		

342810/406307/350144	\$ 1590	26355144
338212/350144	\$ 290	2631431

Please use enclosed envelope to mail receipt.

Thank You.

Brittany Wilson

RECEIVED
BI MAZ STATE OFFICE

2012 AUG 14 P 2:00

PHOENIX, ARIZONA

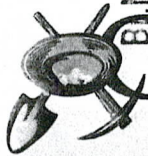

GOLD PROSPECTORS
ASSOCIATION OF AMERICA

P.O. Box 891479 - Temecula, CA 92589-1479
(800) 551-9707 - Fax (951) 699-4062
www.goldprospectors.org

35987
100714
325932
324198
344407
352316
302602
190993
338375
344626
327542
329246
330272
331449
333855
332360
335768
333387
335192
343904
337776
338212
374071
348413
350128
350282
350330
350285
350309
318385
353613
333347
353929
297242
355490
348177
304305
342810
364805
373840
371816
395798
390613
399153
337791
406307
415621
406412

ENTERED IN COMPUTER

RZ 8-23-12

Houston, Annabell

To: Brittany McLeod
Subject: RE: Gold Prospectors Association of America Claims

Brittany,

The charge will be \$49,990.00 since our system will not let us charge anything that is \$49,999.00. The balance is \$35,330.00.

I will mail original documents and receipt in the envelope provided.

Regards,

Annabell Houston
Accounting Technician, CBS Core Team Lead Information Access Center AZ State Office – Bureau of Land Management
1 North Central Ave, Suite 800
Phoenix, AZ. 85004-4427
Tel.: 602-417-9562
Fax: 602-417-9556

-----Original Message-----

From: Brittany McLeod [<mailto:bwilson@goldprospectors.org>]
Sent: Wednesday, August 15, 2012 2:05 PM
To: Houston, Annabell
Subject: Gold Prospectors Association of America Claims

Anabelle,

Please charge the card that you have authorization for in the amount of \$49,999.00 for the claims on the list that I mailed. I will mail out a check today for the remaining balance. Please contact me if you have any challenges or questions. Also, if you could mail me or fax me a receipt it would be greatly appreciated.

fax # 951-699-4062

Brittany Wilson
GPAA
Executive Assistant to Brandon Johnson
951-699-4749 x176
bwilson@goldprospectors.org

ARIZONA

BLM FILING FOR YEAR

RECEIVED
BLM AZ STATE OFFICE

2013

2012 AUG 14 P 2:00

<u>CLAIM NAME</u>	<u>AMC#</u>	<u>CLAIM OWNER</u>	<u>Acres</u>	<u>Amount</u>
1 Yahoo #2	35987	William Cimino, et al	20	\$ 140.00
2 Yahoo #4	100714	P.O. Box 416 Morristown, AZ 85342	20	\$ 140.00
3 Golden Dreams #A	325932	John Simpson, et al	40	\$ 280.00
4 #1 King Mining	324198	18230 N. 32 Lane Phoenix, AZ 85023	20	\$ 140.00
5 Wandering Star	344407	Scott Homan, et al 9492 E. Caldwell Drive Tucson, Az. 85747	160	\$ 1,120.00
6 PC 2	352316	Tom Tierney, et al	40	\$ 280.00
7 Big Four #1	302602	P.O. Box 1415	20	\$ 140.00
8 Big Four #2	302603	Sierra Vista, AZ 85636	20	\$ 140.00
9 Big Four #3	302604		20	\$ 140.00
10 Lost Dutchman	190993	Lost Dutchman Mining Assn. 43445 Business Park Dr #113 Temecula, CA 92590	120	\$ 840.00
11 Az Au #1	338375	Gold Prospectors Assn of America	20	\$ 140.00
12 Az Au #2	338376	P.O. Box 891509 Temecula, CA 92589-1509	20	\$ 140.00
13 Lucky 13	344626	Bob Wilke, et al 8711 W Sierra Vista Drive Glendale, AZ 85305	160	\$ 1,120.00

PHOENIX, ARIZONA

NO. OF CLAIMS 701
AMOUNT \$49,999.00
RECEIPT NO. 26143
INIT. [Signature]

** BLM-ASO **

4480
4760

\$4,960

ARIZONA

\$4760

BLM FILING FOR YEAR

RECEIVED
BLM AZ STATE OFFICE

2013

<u>CLAIM NAME</u>	<u>AMC#</u>	<u>CLAIM OWNER</u>	<u>Acres</u>	<u>Amount</u>
14 Bahde #10	327542	Clarence Bahde, et al	160	\$ 1,120.00
15 Bahde #11	329246	306 Lakeview	160	\$ 1,120.00
16 Bahde #12	329247	Boulder City, NV 89005	160	\$ 1,120.00
17 Bahde #13	329248		160	\$ 1,120.00
18 Bahde #14	329249		160	\$ 1,120.00
19 Bahde #17	330272		160	\$ 1,120.00
20 Bahde #18	330273		160	\$ 1,120.00
21 Friendship	331449	John Reddoch, et al	160	\$ 1,120.00
22 Lucky Strike	333855	3237 E Holliday Street	160	\$ 1,120.00
23 R Double J	332360	Tucson, AZ 85706	70	\$ 560.00
24 Fantastic	335768		160	\$ 1,120.00
25 Golden Tattoo	333387	Jeff Fuhrmann, et al P.O Box 3357 Camp Verde, AZ 86322	160	\$ 1,120.00
26 Firehouse	335192	James D. Riddenhour, Sr, et al	80	\$ 560.00
27 Soldier Boy	343903	3914 N. Hawes	160	\$ 1,120.00
28 Double JJ	343904	Mesa, AZ 85207	160	\$ 1,120.00
29 Gorbett Association	337776	Gordon Howcroft, et al 19542 Apache Road Bend, OR 97702	160	\$ 1,120.00
30 Think it Has	338212	Gilbert Binns, et al Box 9000-1578 Quartzsite, AZ 85346	40	\$ 480.00 280

PHOENIX, ARIZONA

\$17,080
total = \$22,040 21840

ARIZONA

BLM FILING FOR YEAR

RECEIVED
BLM AZ STATE OFFICE

2013

↓
~~\$22,040~~
21,840

CLAIM NAME

AMC#

CLAIM OWNER

012 AUG 14 P 2:00

Acres

Amount

31	Beau Star	374071	Ken Rucker, et al 43445 Business Park Drive Temecula, CA 92590	20.66	\$ 140.00
32	Abracadabra 1	348413	Kent Reed, et al	160	\$ 1,120.00
33	Abracadabra 2	348414	3426 W. Glen Rosa	160	\$ 1,120.00
34	Abracadabra 3	348415	Phoenix, AZ. 85023	160	\$ 1,120.00
35	Abracadabra 4	348416		160	\$ 1,120.00
✓36	Abracadabra 5	350128	Alaric M Woodward, et al	160	\$ 1,120.00
✓37	Abracadabra 6	350129	2644 W. San Miguel Phoenix, AZ. 85017	160	\$ 1,120.00
✓38	Abracadabra 7	350130	John Albanese, et al 3856 W. Country Gables Dr. Phoenix, AZ. 85027	160	\$ 1,120.00
39	Abracadabra 9	350282	George James, et al 8569 E. Modlock Dr. Glendale, AZ. 85305	160	\$ 1,120.00
✓40	Abracadabra 10	350131	Mary Briggs, et al 2139 W. Elm Phoenix, Az. 85015	160	\$ 1,120.00

over

\$ 10,220

total = \$ ~~32,260~~

32,060

ARIZONA

BLM FILING FOR YEAR

RECEIVED
BLMAZ STATE OFFICE

2013

~~\$32,260~~
\$32,060

2012 AUG 14 P 2:00

<u>CLAIM NAME</u>	<u>AMC#</u>	<u>CLAIM OWNER</u>	<u>Acres</u>	<u>Amount</u>
✓41 Abracadabra 11	350132	George James, et al 8569 E. Modlock Dr. Glendale, AZ. 85305	160	\$ 1,120.00
✓42 Abracadabra 12	350133	Mary Briggs, et al 2139 W. Elm Phoenix, AZ. 85015	160	\$ 1,120.00
✓43 Abracadabra 13	350134	John Abanese, et al	160	\$ 1,120.00
✓44 Abracadabra 14	350135	3856 W. Country Gables	160	\$ 1,120.00
✓45 Abracadabra 15	350136	Phoenix, AZ. 85023	160	\$ 1,120.00
✓46 Abracadabra 16	350137	Mary Briggs, et al	160	\$ 1,120.00
✓47 Abracadabra 17	350138	2139 W Elm Phoenix, AZ. 85015	160	\$ 1,120.00
✓48 Abracadabra 18	350139	Chris Zollinger, et al 18812 N. 19 th Dr. Phoenix, AZ. 85027	160	\$ 1,120.00
✓49 Abracadabra 19	350140	Mary Briggs, et al 2139 W. Elm Phoenix, AZ. 85015	160	\$ 1,120.00
50 Abracadabra 20	350141	Chris Zollinger, et al 18812 N. 19 th Dr. Phoenix, AZ. 85027	160	\$ 1,120.00

\$ 12,200
43,260
total = \$ ~~12,200~~
42,460

ARIZONA

BLM FILING FOR YEAR

RECEIVED
BLMAZ STATE OFFICE

~~\$43,460~~
\$43,460
\$43,260 2013

2012 AUG 14 P 2:00

PHOENIX, ARIZONA

CLAIM NAME AMC# CLAIM OWNER Acres Amount

✓ 51	Abracadabra 21	350142	Ron Irvine, et al 7108 W. Mulberry Phoenix, AZ. 85033	160	\$ 1,120.00	44,580 44,380
✓ 52	Bonanza 1	350330	Ron Irvine, et al 7108 W. Irvine Phoenix, AZ. 85033	160	\$ 1,120.00	45,700 45,500
✓ 53	Calamity 1	350143	Jeanne B. Spinella, et al 1747 E. Northern Ave. #150 Phoenix, AZ. 85020	160	\$ 1,120.00	46,820 46,620
✓ 54	Calamity 2	350144	Terry Huff, et al 15860 N. 61 st St. Scottsdale, AZ. 85254	133.4	\$ 1,120.00	47,800 47,600
✓ 55	Calamity 3	350285	Ron Irvine, et al	160	\$ 1,120.00	48,920 48,720
✓ 56	Calamity 4	350286	7108 W. Irvine	160	\$ 1,120.00 - Receipt #	
✓ 57	Calamity 5	350309	Phoenix, AZ. 85033	80	\$ 560.00 - 2635544	
✓ 58	Calamity 8	350310	Bruce Austin, et al	106.7	\$ 840.00	49,560 49,760
✓ 59	Calamity 9	350311	1714 W. Stottler Dr. Chandler, AZ. 85224	115	\$ 840.00	

2635544

Receipt #
2631431
\$ 8,820
~~\$ 43,460~~
\$ 27,780

~~\$53,480~~
\$52,280

ARIZONA

BLM FILING FOR YEAR

RECEIVED
BLM AZ STATE OFFICE

2013

<u>CLAIM NAME</u>	<u>AMC#</u>	<u>CLAIM OWNER</u>	2012 AUG 14 <u>Acres</u>	<u>Amount</u>
60 OHMI #23	318388	Richard & Cora Moore, et al 1613 E. Portola Ave. Santa Ana, CA 92701	4	\$ 280.00
61 Maybe, Maybe Not	353613	Richard E Conway, et al 3330 E. 1 st St. Tucson, AZ. 85711	160	\$ 1,120.00
62 Wet Rock	353614	Kathy Homan, et al 9492 E. Caldwell DR. Tucson, AZ. 85747	160	\$ 1,120.00
63 DumbLuck	333347	Woody Wampler, et al 956 Greenbriar Cr. Mesa, AZ. 85201	40	\$ 280.00
64 Bull Tales	353929	Bud Riley, et al 8228 E. Cypress ST. Scottsdale, AZ. 85257	20	\$ 140.00
65 Mighty Find	297243	Steve Short, et al	44.44	\$ 420.00
66 Square Bear	297244	14641 N 90th Lane	37.61	\$ 280.00
67 Little Richer	297245	Peoria, AZ 85381	22.31	\$ 280.00
68 Golden Gobbler	355490	Bud Riley, et al 8228 E. Cypress ST. Scottsdale, AZ. 85257	41.2	\$ 420.00

Earned by
R-
631431
\$49,900

\$ 4,340
\$56,620
~~\$87,500~~

ARIZONA

BLM FILING FOR YEAR

RECEIVED
BLMAZ STATE OFFICE

~~\$51,820~~
\$56,620

2013

CLAIM NAME

AMC#

CLAIM OWNER

2012 AUG 14 P 2

Acres

Amount

69	Pickem up Again	348177	Ernest L. Leschner, et al	40	\$ 280.00
70	Pickem up 1	304305	48820 N US HWY 60	20.66	\$ 140.00
71	Pickem up 2	304306	Morristown, AZ 85342	20.66	\$ 140.00
72	Pickem up 3	304307		20.66	\$ 140.00
73	Polaris	342811	Paul Neff, et al HC 70 Box 5471 Sahuarita, AZ. 85629	59.7	\$ 420.00
74	Hercules	342810	Paul Neff, et al HC 70 Box 5471 Sahuarita, AZ. 85629	160	\$ 1,120.00
75	Flat Foot	364805	Dwayne Farmer, et al 5915 Colorada River RD. Blythe, CA. 92225	160	\$ 1,120.00
76	Little Picker	373840	G.P.A.A.	160	\$ 1,120.00
77	Green Grease	373841	Ken Rucker, et al	160	\$ 1,120.00
78	Cat Claw	373842	43445 Business Park Dr #113	160	\$ 1,120.00
79	Oly Pop	373843	Temecula, CA 92590	160	\$ 1,120.00
80	Sarah P	373844		160	\$ 1,120.00
81	Desert Panner	373845		160	\$ 1,120.00
82	Baker Inn	373846		160	\$ 1,120.00
83	The Strut	373847		160	\$ 1,120.00

\$ 12,320

\$68,940

~~\$70,140~~

-check areas
CR2K=57.8

3,960 12,740

12,740

ARIZONA

BLM FILING FOR YEAR

~~\$70,140~~
\$68,940

2013

RECEIVED
BLM AZ STATE OFFICE

2012 AUG 14 P 2:01

PHOENIX, ARIZONA

	<u>CLAIM NAME</u>	<u>AMC#</u>	<u>CLAIM OWNER</u>	<u>Acres</u>	<u>Amount</u>
84	Hoppy 1	371816	Frank J. Moore, et al	160	\$1,120.00
85	Hoppy 2	371817	3685 W Maulding AVE	160	\$1,120.00
86	Hoppy 3	371818	Las Vegas, NV 89139	160	\$1,120.00
87	Hoppy 4	371819		160	\$1,120.00
88	C-JEM	395798	James Ebel, et al 14306 Williamsburg St Riverview, MI 48193	20.66	\$ 140.00
89	Gold Flatz #1	390613	Brent Gould, et al	160	\$1,120.00
90	Gold Flatz #2	390614	17200 West Bell Rd Surprise, AZ 85374	160	\$1,120.00
91	SURE FIND	399153	Steve Short, et al	20	\$ 140.00
92	YB WORKIN	399154	14641 N 90th Lane	20	\$ 140.00
93	VENTURE II	337791	Peoria, AZ 85381	20	\$ 140.00
94	EDS Dirt	406307	Ed Severance, et al 201 Vallejo Ave Las Vegas, NV 89110	160	\$ 1,120.00 2,800.00
95	CONGRESS GOLD #1	415621	Brandon Johnson, et al	160	\$1,120.00
96	CONGRESS GOLD #2	415622	43445 Business Park Drive Ste 113	160	\$1,120.00
97	CONGRESS GOLD #3	415623	Temecula, CA 92590	160	\$1,120.00
98	CONGRESS GOLD #4	415624		160	\$1,120.00
99	CONGRESS GOLD #5	415625		160	\$1,120.00
100	CONGRESS GOLD #6	415626		160	\$1,120.00

840

verified in case
as 40 acres
RE 10-17

13,480

92,250

15,120
84,060
~~68,940~~

ARIZONA

BLM FILING FOR YEAR

RECEIVED
BLM AZ STATE OFFICE

2013

CLAIM NAME

AMC#

CLAIM OWNER

2012 AUG 14 P 2:01

Acres

Amount

101	Vulture Bait	406412	Albert L Barton, et al 1505 N La Fresa Dr Goodyear, AZ 85338	PHOENIX, ARIZONA 160	\$ 1,120.00
-----	--------------	--------	--	----------------------	-------------

Total Acres 11883.6
Total Amount Submitted \$85,320.00
Pay By Credit Card. Authorization Form Attached

By:
Gold Prospectors Association of America
43445 Business Park Dr #113
Temecula, CA 92590
800-551-9707

Walt Eason / Blake Harmon

thought to owe: \$85,180

84060
1120
85180

~~85180~~

~~85180~~

85180

85320
85180
140

140
140
40

54
11883
100
180
180

United States Department of the Interior
Bureau of Land Management
 LANDS/RECREATION & PLANNING
 ONE N CENTRAL AVE
 PHOENIX, AZ 85004 -2203
 Phone: 602-417-9200

Receipt

No: 2631431

Transaction #: 2711921	
Date of Transaction: 08/15/2012	
CUSTOMER:	
GOLD PROSPECTORS ASSOCIATION PO BOX 891509 TEMECULA, CA 92589-1509 US	

LINE #	QTY	DESCRIPTION	REMARKS	UNIT PRICE	TOTAL
1	1.00	LOCATABLE MINERALS / MINING CLAIMS-NOT NEW-UNADJUD, ONE AUTH NO. ONLY / MINING CLAIM MONEY RECEIVED CASES: AMC35987/\$49990.00	MAINT FEE PYMNT (101) 2013	- n/a -	49990.00
TOTAL:					\$49,990.00

PAYMENT INFORMATION			
NOTE: Items will appear on credit card statement as "Bureau of Land Mgmt CO".			
1	AMOUNT:	49990.00	POSTMARKED: N/A
	TYPE:	CREDIT CARD	RECEIVED: 08/15/2012
	NAME:	JOHNSON, BRANDON PO BOX 891509 TEMECULA CA 92589-1509 US	
	CARD NO:	XXXXXXXXXXXX6575	AUTH CODE: 61516G
	NAME ON CARD:	BRANDON JOHNSON	
	EXPIRES:	03/2014	
	SIGNATURE:		

REMARKS

This receipt was generated by the automated BLM Collections and Billing System and is a paper representation of a portion of the official electronic record contained therein.

\$290 refund authorized for maint fee ^{over} paid on AMC 350144 (\$90) and AMC 338212 (\$200)
 RE 10-17-12*

** remainder of overpayment refunded to receipt # 2635544*

10

357

49,990.

420

799

200

990

980

140

**United States Department of the Interior
Bureau of Land Management**

LANDS/RECREATION & PLANNING
ONE N CENTRAL AVE
PHOENIX, AZ 85004 -2203
Phone: 602-417-9200

Receipt

No: 2635544

Transaction #: 2716114	
Date of Transaction: 08/21/2012	
CUSTOMER:	
GOLD PROSPECTORS ASSOCIATION PO BOX 891509 TEMECULA, CA 92589-1509 US	

LINE #	QTY	DESCRIPTION	REMARKS	UNIT PRICE	TOTAL
1	1.00	LOCATABLE MINERALS / MINING CLAIMS-NOT NEW-UNADJUD, ONE AUTH NO. ONLY / MINING CLAIM MONEY RECEIVED CASES: AMC35987/\$35330.00	MAINT FEE PYMNT (101) 2013	- n/a -	35330.00
TOTAL:					\$35,330.00

PAYMENT INFORMATION			
1	AMOUNT:	35330.00	POSTMARKED: N/A
	TYPE:	CHECK	RECEIVED: 08/20/2012
	CHECK NO:	38973	
	NAME:	GOLD PROSPECTORS ASSOCIATION 43445 BUSINESS PARK CTR #113 TEMECULA CA 92590 US	

REMARKS

This receipt was generated by the automated BLM Collections and Billing System and is a paper representation of a portion of the official electronic record contained therein.

*\$1590 refund authorized
for maint fees overpaid on
AMC 342810 (\$700), AMC 406307 (\$840)
& AMC 350144 (\$50)**

252
~~35330~~
~~140~~ 280
~~233~~
~~200~~
~~330~~
~~270~~
~~20~~

** remainder of overpayment refunded to*



Gold Prospectors Association of America

P.O. Box 891509 Temecula, CA 92589 (951) 699-4749

August 16, 2012

Enclosed you will find a check in the amount of \$35,330.00 to be put towards the remaining balance of the claims to be paid by the Gold Prospectors Association of America.

If you have any questions or concerns regarding payment or the claims listed, please do not hesitate to call me directly.

Have a great day.

Brittany Wilson

GPAA Executive Assistant

951-699-4749 x176

RECEIVED
BLM AZ STATE OFFICE
2012 AUG 20 P 2:16
PHOENIX, ARIZONA

2nd pmt - Find paperwork

Red entered

\$1590 left

NO. OF CLAIMS 101
AMOUNT \$35,330.00
RECEIPT NO. 2635544
NIT. CAH

** BLM-ASO **

ARIZONA

BLM FILING FOR YEAR

RECEIVED
BLM AZ STATE OFFICE

2013

2012 AUG 20 P 2: 17

CLAIM NAME

AMC#

CLAIM OWNER

Acres

Amount

PHOENIX, ARIZONA

1	Yahoo #2	35987	William Cimino, et al	20	\$ 140.00
2	Yahoo #4	100714	P.O. Box 416 Morristown, AZ 85342	20	\$ 140.00
3	Golden Dreams #A	325932	John Simpson, et al	40	\$ 280.00
4	#1 King Mining	324198	18230 N. 32 Lane Phoenix, AZ 85023	20	\$ 140.00
5	Wandering Star	344407	Scott Homan, et al 9492 E. Caldwell Drive Tucson, Az. 85747	160	\$ 1,120.00
6	PC 2	352316	Tom Tierney, et al	40	\$ 280.00
7	Big Four #1	302602	P.O. Box 1415	20	\$ 140.00
8	Big Four #2	302603	Sierra Vista, AZ 85636	20	\$ 140.00
9	Big Four #3	302604		20	\$ 140.00
10	Lost Dutchman	190993	Lost Dutchman Mining Assn. 43445 Business Park Dr #113 Temecula, CA 92590	120	\$ 840.00
11	Az Au #1	338375	Gold Prospectors Assn of America	20	\$ 140.00
12	Az Au #2	338376	P.O. Box 891509 Temecula, CA 92589-1509	20	\$ 140.00
13	Lucky 13	344626	Bob Wilke, et al 8711 W Sierra Vista Drive Glendale, AZ 85305	160	\$ 1,120.00

ARIZONA

BLM FILING FOR YEAR

RECEIVED
BLM AZ STATE OFFICE

2013

2012 AUG 20 P 2: 17

CLAIM NAME

AMC#

CLAIM OWNER

Acres

Amount

PHOENIX, ARIZONA

14	Bahde #10	327542	Clarence Bahde, et al	160	\$ 1,120.00
15	Bahde #11	329246	306 Lakeview	160	\$ 1,120.00
16	Bahde #12	329247	Boulder City, NV 89005	160	\$ 1,120.00
17	Bahde #13	329248		160	\$ 1,120.00
18	Bahde #14	329249		160	\$ 1,120.00
19	Bahde #17	330272		160	\$ 1,120.00
20	Bahde #18	330273		160	\$ 1,120.00
21	Friendship	331449	John Reddoch, et al	160	\$ 1,120.00
22	Lucky Strike	333855	3237 E Holliday Street	160	\$ 1,120.00
23	R Double J	332360	Tucson, AZ 85706	70	\$ 560.00
24	Fantastic	335768		160	\$ 1,120.00
25	Golden Tattoo	333387	Jeff Fuhrmann, et al P.O Box 3357 Camp Verde, AZ 86322	160	\$ 1,120.00
26	Firehouse	335192	James D. Riddenhour, Sr, et al	80	\$ 560.00
27	Soldier Boy	343903	3914 N. Hawes	160	\$ 1,120.00
28	Double JJ	343904	Mesa, AZ 85207	160	\$ 1,120.00
29	Gorbert Association	337776	Gordon Howcroft, et al 19542 Apache Road Bend, OR 97702	160	\$ 1,120.00
30	Think it Has	338212	Gilbert Binns, et al Box 9000-1578 Quartzsite, AZ 85346	40	\$ 480.00 280.00 AD

ARIZONA

BLM FILING FOR YEAR

RECEIVED
BLM AZ STATE OFFICE

2013

2012 AUG 20 P 2: 20

CLAIM NAME **AMC#** **CLAIM OWNER** **Acres** **Amount**
PHOENIX, ARIZONA

31	Beau Star	374071	Ken Rucker, et al 43445 Business Park Drive Temecula, CA 92590	20.66	\$ 140.00
32	Abracadabra 1	✓ 348413	Kent Reed, et al	160	\$ 1,120.00
33	Abracadabra 2	✓ 348414	3426 W. Glen Rosa	160	\$ 1,120.00
34	Abracadabra 3	✓ 348415	Phoenix, AZ. 85023	160	\$ 1,120.00
35	Abracadabra 4	✓ 348416		160	\$ 1,120.00
36	Abracadabra 5	✓ 350128	Alaric M Woodward, et al	160	\$ 1,120.00
37	Abracadabra 6	✓ 350129	2644 W. San Miguel Phoenix, AZ. 85017	160	\$ 1,120.00
38	Abracadabra 7	✓ 350130	John Albanese, et al 3856 W. Country Gables Dr. Phoenix, AZ. 85027	160	\$ 1,120.00
39	Abracadabra 9	✓ 350282	George James, et al 8569 E. Modlock Dr. Glendale, AZ. 85305	160	\$ 1,120.00
40	Abracadabra 10	✓ 350131	Mary Briggs, et al 2139 W. Elm Phoenix, Az. 85015	160	\$ 1,120.00

ARIZONA

BLM FILING FOR YEAR

RECEIVED
BLM AZ STATE OFFICE

2013

CLAIM NAME

AMC#

CLAIM OWNER

2012 AUG 20 P 2: 20

Acres

Amount

PHOENIX, ARIZONA

41	Abracadabra 11	✓350132	George James, et al 8569 E. Modlock Dr. Glendale, AZ. 85305	160	\$ 1,120.00
42	Abracadabra 12	✓350133	Mary Briggs, et al 2139 W. Elm Phoenix, AZ. 85015	160	\$ 1,120.00
43	Abracadabra 13	✓350134	John Abanese, et al	160	\$ 1,120.00
44	Abracadabra 14	✓350135	3856 W. Country Gables	160	\$ 1,120.00
45	Abracadabra 15	✓350136	Phoenix, AZ. 85023	160	\$ 1,120.00
46	Abracadabra 16	✓350137	Mary Briggs, et al	160	\$ 1,120.00
47	Abracadabra 17	✓350138	2139 W Elm Phoenix, AZ. 85015	160	\$ 1,120.00
48	Abracadabra 18	✓350139	Chris Zollinger, et al 18812 N. 19 th Dr. Phoenix, AZ. 85027	160	\$ 1,120.00
49	Abracadabra 19	✓350140	Mary Briggs, et al 2139 W. Elm Phoenix, AZ. 85015	160	\$ 1,120.00
50	Abracadabra 20	✓350141	Chris Zollinger, et al 18812 N. 19 th Dr. Phoenix, AZ. 85027	160	\$ 1,120.00

ARIZONA

BLM FILING FOR YEAR

RECEIVED
BLM AZ STATE OFFICE

2013

CLAIM NAME

AMC#

CLAIM OWNER

2012 AUG 20 P 2: 20

Acres

Amount

PHOENIX, ARIZONA

51	Abacadabra 21	✓350142	Ron Irvine, et al 7108 W. Mulberry Phoenix, AZ. 85033	160	\$ 1,120.00
52	Bonanza 1	✓350330	Ron Irvine, et al 7108 W. Irvine Phoenix, AZ. 85033	160	\$ 1,120.00
53	Calamity 1	✓350143	Jeanne B. Spinella, et al 1747 E. Northern Ave. #150 Phoenix, AZ. 85020	160	\$ 1,120.00
54	Calamity 2	✓350144	Terry Huff, et al 15860 N. 61 st St. Scottsdale, AZ. 85254	133.4	\$ 1,120.00
55	Calamity 3	✓350285	Ron Irvine, et al	160	\$ 1,120.00
56	Calamity 4	✓350286	7108 W. Irvine	160	\$ 1,120.00
57	Calamity 5	350309	Phoenix, AZ. 85033	80	\$ 560.00
58	Calamity 8	350310	Bruce Austin, et al	106.7	\$ 840.00
59	Calamity 9	350311	1714 W. Stottler Dr. Chandler, AZ. 85224	115	\$ 840.00

ARIZONA

BLM FILING FOR YEAR

RECEIVED
BLM AZ STATE OFFICE

2013

<u>CLAIM NAME</u>	<u>AMC#</u>	<u>CLAIM OWNER</u>	<u>Acres</u>	<u>Amount</u>
60 OHMI #23	318388	Richard & Cora Moore, et al 1613 E. Portola Ave. Santa Ana, CA 92701	50	\$ 280.00
61 Maybe, Maybe Not	353613	Richard E Conway, et al 3330 E. 1 st St. Tucson, AZ. 85711	160	\$ 1,120.00
62 Wet Rock	353614	Kathy Homan, et al 9492 E. Caldwell DR. Tucson, AZ. 85747	160	\$ 1,120.00
63 DumbLuck	333347	Woody Wampler, et al 956 Greenbriar Cr. Mesa, AZ. 85201	40	\$ 280.00
64 Bull Tales	353929	Bud Riley, et al 8228 E. Cypress ST. Scottsdale, AZ. 85257	20	\$ 140.00
65 Mighty Find	297243	Steve Short, et al	44.44	\$ 420.00
66 Square Bear	297244	14641 N 90th Lane	37.61	\$ 280.00
67 Little Richer	297245	Peoria, AZ 85381	22.31	\$ 280.00
68 Golden Gobbler	355490	Bud Riley, et al 8228 E. Cypress ST. Scottsdale, AZ. 85257	41.2	\$ 420.00

ARIZONA

BLM FILING FOR YEAR

RECEIVED
BLM AZ STATE OFFICE

2013

2012 AUG 20 P 2: 20

CLAIM NAME **AMC#** **CLAIM OWNER** **Acres** **Amount**
PHOENIX, ARIZONA

69	Pickem up Again	348177	Ernest L. Leschner, et al	40	\$ 280.00
70	Pickem up 1	304305	48820 N US HWY 60	20.66	\$ 140.00
71	Pickem up 2	304306	Morristown, AZ 85342	20.66	\$ 140.00
72	Pickem up 3	304307		20.66	\$ 140.00
73	Polaris	342811	Paul Neff, et al HC 70 Box 5471 Sahuarita, AZ. 85629	59.7	\$ 420.00
74	Hercules	342810	Paul Neff, et al HC 70 Box 5471 Sahuarita, AZ. 85629	160	\$ 1,120.00
75	Flat Foot	364805	Dwayne Farmer, et al 5915 Colorada River RD. Blythe, CA. 92225	160	\$ 1,120.00
76	Little Picker	373840	G.P.A.A.	160	\$ 1,120.00
77	Green Grease	373841	Ken Rucker, et al	160	\$ 1,120.00
78	Cat Claw	373842	43445 Business Park Dr #113	160	\$ 1,120.00
79	Oly Pop	373843	Temecula, CA 92590	160	\$ 1,120.00
80	Sarah P	373844		160	\$ 1,120.00
81	Desert Panner	373845		160	\$ 1,120.00
82	Baker Inn	373846		160	\$ 1,120.00
83	The Strut	373847		160	\$ 1,120.00

ARIZONA

BLM FILING FOR YEAR

RECEIVED
BLM AZ STATE OFFICE

2013

<u>CLAIM NAME</u>	<u>AMC#</u>	<u>CLAIM OWNER</u>	<u>Acres</u>	<u>Amount</u>
2012 AUG 20 P 2: 20 PHOENIX, ARIZONA				
84 Hoppy 1	371816	Frank J. Moore, et al	160	\$ 1,120.00
85 Hoppy 2	371817	3685 W Maulding AVE	160	\$ 1,120.00
86 Hoppy 3	371818	Las Vegas, NV 89139	160	\$ 1,120.00
87 Hoppy 4	371819		160	\$ 1,120.00
88 C-JEM	395798	James Ebel, et al 14306 Williamsburg St Riverview, MI 48193	20.66	\$ 140.00
89 Gold Flatz #1	390613	Brent Gould, et al	160	\$ 1,120.00
90 Gold Flatz #2	390614	17200 West Bell Rd Surprise, AZ 85374	160	\$ 1,120.00
91 SURE FIND	399153	Steve Short, et al	20	\$ 140.00
92 YB WORKIN	399154	14641 N 90th Lane	20	\$ 140.00
93 VENTURE II	337791	Peoria, AZ 85381	20	\$ 140.00
94 EDS Dirt	406307	Ed Severance, et al 201 Vallejo Ave Las Vegas, NV 89110	160	\$ 1,120.00
95 CONGRESS GOLD #1	415621	Brandon Johnson, et al	160	\$ 1,120.00
96 CONGRESS GOLD #2	415622	43445 Business Park Drive Ste 113	160	\$ 1,120.00
97 CONGRESS GOLD #3	415623	Temecula, CA 92590	160	\$ 1,120.00
98 CONGRESS GOLD #4	415624		160	\$ 1,120.00
99 CONGRESS GOLD #5	415625		160	\$ 1,120.00
100 CONGRESS GOLD #6	415626		160	\$ 1,120.00

ARIZONA

BLM FILING FOR YEAR

2013

<u>CLAIM NAME</u>	<u>AMC#</u>	<u>CLAIM OWNER</u>	<u>Acres</u>	<u>Amount</u>
101 Vulture Bait	✓ 406412	Albert L Barton, et al 1505 N La Fresa Dr Goodyear, AZ 85338	160	\$ 1,120.00

Total Acres 11883.6
Total Amount Submitted \$85,320.00
Pay By Credit Card. Authorization Form Attached

By:
Gold Prospectors Association of America
43445 Business Park Dr #113
Temecula, CA 92590
800-551-9707 Walt Eason / Blake Harmon



PO BOX 891509
TEMECULA, CA 92589-1509

RECEIVED
BLM AZ STATE OFFICE
2012 AUG 20 P 2:16
PHOENIX, ARIZONA

BLM Arizona State Office
1 North Central Ave.
Pheonix, Az 85004

SHIPPER (957) 699-4749 1 LBS 1 OF 1
GPM SHIPPING DEPARTMENT DWT: 14.14.4
STE 113
4345 BUSINESS PARK DR
TEMECULA CA 92590-3671

SHIP TO BLM ARIZONA STATE OFFICE
951-699-4749
BLM ARIZONA STATE OFFICE
1 NORTH CENTRAL AVE

PHEONIX AZ 85004



AZ 850 9-10



JPS 2ND DAY AIR

TRACKING #: 1Z 9E5 453 36 0072 7637

2



BILLING: P/P

Ship Date: 08/16/12
Reference:

Bill Nr.: 94009
Reference 2:

PBE 0660 PR 1000 08/2012

P: PURPLE S: ORANGE I: 44A

0904-5000

BLM ARIZONA STATE OFFICE
1 N CENTRAL AVE
PHOENIX AZ 85004-4414

120E5453360072 **7637**
SAT08485 Aug 20 04:59:53 2012
US 8501 HIPP 11.1.3 SAT084852e

United States Department of the Interior
Bureau of Land Management
 LANDS/RECREATION & PLANNING
 ONE N CENTRAL AVE
 PHOENIX, AZ 85004 -2203
 Phone: 602-417-9200

Receipt

No: 2635544

Transaction #: 2716114	
Date of Transaction: 08/21/2012	
CUSTOMER:	
GOLD PROSPECTORS ASSOCIATION PO BOX 891509 TEMECULA, CA 92589-1509 US	

LINE #	QTY	DESCRIPTION	REMARKS	UNIT PRICE	TOTAL
1	1.00	LOCATABLE MINERALS / MINING CLAIMS-NOT NEW-UNADJUD, ONE AUTH NO. ONLY / MINING CLAIM MONEY RECEIVED CASES: AMC35987/\$35330.00	MAINT FEE PYMNT (101) 2013	- n/a -	35330.00
TOTAL:					\$35,330.00

PAYMENT INFORMATION			
1	AMOUNT:	35330.00	POSTMARKED: N/A
	TYPE:	CHECK	RECEIVED: 08/20/2012
	CHECK NO:	38973	
	NAME:	GOLD PROSPECTORS ASSOCIATION 43445 BUSINESS PARK CTR #113 TEMECULA CA 92590 US	

REMARKS

This receipt was generated by the automated BLM Collections and Billing System and is a paper representation of a portion of the official electronic record contained therein.

AMC 35987
AMC 100714
AMC 190993
AMC 297242
AMC 302602
AMC 304305
AMC 318385
AMC 324198
AMC 325932
AMC 327542
AMC 329246
AMC 330272
AMC 331449
AMC 332360
AMC 333347
AMC 333387
AMC 333855
AMC 335192
AMC 335768
AMC 337776
AMC 337791
AMC 338212

AMC 338375
AMC 342810
AMC 343903
AMC 344407
AMC 344626
AMC 348177
AMC 348413
AMC 350128
AMC 350282
AMC 350285
AMC 350309
AMC 352316
AMC 353613
AMC 353929
AMC 355490
AMC 364805
AMC 371816
AMC 373840
AMC 374071
AMC 390613
AMC 399153
AMC 371201
AMC 367716
AMC 371371
AMC 371062
AMC 370751
AMC 395798

RE 10/31/11

attached
see receipt 2421063
\$980 ~~Refund~~ Authorized
MFS paid on closed claims
(AMC ~~371201~~, AMC 367716, AMC 371371,
AMC 371063, AMC 370752) and
duplicate MFS pd on AMC 395798 & AMC 337791

ARIZONA

BLM FILING FOR YEAR

2012

	<u>CLAIM NAME</u>	<u>AMC#</u>	<u>CLAIM OWNER</u>
1	Yahoo #2 ✓	35987 ✓	William Cimino
2	Yahoo #4 ✓	100714 ✓	P.O. Box 416 Morristown, AZ 85342
3	Golden Dreams #A ✓	325932 ✓	John Simpson, et al
4	#1 King Mining ✓	OK 324198 ✓	18230 N. 32 Lane Phoenix, AZ 85023
5	Wandering Star ✓	344407 ✓	Scott Homan, et al 9492 E. Caldwell Drive Tucson, Az. 85747
6	PC 2 ✓	352316 ✓	Tom Tierney
7	Big Four #1 ✓	302602	P.O. Box 1415
8	Big Four #2 ✓	302603	Sierra Vista, AZ 85636
9	Big Four #3 ✓	302604 ✓	
10	Lost Dutchman ✓	190993 ✓	Lost Dutchman Mining Assn. 43445 Business Park Dr #113 Temecula, CA 92590
11	Az Au #1 ✓	338375	Gold Prospectors Assn of America
12	Az Au #2 ✓	338376 ✓	P.O. Box 891509 Temecula, CA 92589-1509
13	Lucky 13 ✓	344626 ✓	Bob Wilke, et al 8711 W Sierra Vista Drive Glendale, AZ 85305
14	Bahde #10 ✓	327542 ✓	Clarence Bahde, et al
15	Bahde #11 ✓	329246	306 Lakeview
16	Bahde #12 ✓	329247	Boulder City, NV 89005
17	Bahde #13 ✓	329248	
18	Bahde #14 ✓	329249 ✓	
19	Bahde #17 ✓	330272	
20	Bahde #18 ✓	330273 ✓	

SEP 8 2011
Am

NO. OF CLAIMS 100
AMOUNT \$14,000.00
RECEIPT NO. 2421063
INIT. ADL
** BLM-ASO**

RECEIVED
BLM OFFICE
SEP 29 10:16

ARIZONA

BLM FILING FOR YEAR

2012

<u>CLAIM NAME</u>	<u>AMC#</u>	<u>CLAIM OWNER</u>
21 Friendship ✓	331449 ✓	John Reddoch, et al
22 Lucky Strike ✓	333855 ✓	3237 E Holliday Street
23 R Double J ✓	332360 ✓	Tucson, AZ 85706
24 Fantastic ✓	335768 ✓	
25 Golden Tattoo ✓	333387 ✓	
26 Firehouse ✓	335192 ✓	James D. Riddenhour, Sr
27 Soldier Boy ✓	343903	3914 N. Hawes
28 Double JJ ✓	343904 ✓	Mesa, AZ 85207
29 Gorbert Association ✓	337776 ✓	Gordon Howcroft, et al 19542 Apache Road Bend, OR 97702
30 Think It Has ✓	338212 ✓	Gilbert Binns, et al Box 9000-1578 Quartzsite, AZ 85346
31 Beau Star ✓	374071 ✓	Ken Rucker 43445 Business Park Drive Temecula, CA 92590
32 Abracadabra 1 ✓	348413	Kent Reed, et al
33 Abracadabra 2 ✓	348414	3426 W. Glen Rosa
34 Abracadabra 3 ✓	348415	Phoenix, AZ. 85023
35 Abracadabra 4 ✓	348416 ✓	
36 Abracadabra 5 ✓	350128	Alaric M Woodward, et al
37 Abracadabra 6 ✓	350129 ✓	2644 W. San Miguel Phoenix, AZ. 85017
38 Abracadabra 7 ✓	350130 ✓	John Albanese, et al 3856 W. Country Gables Dr. Phoenix, AZ. 85027
39 Abracadabra 9 ✓	350282 ✓	George James, et al 8569 E. Modlock Dr. Glendale, AZ. 85305

ARIZONA
10/15/12

ARIZONA

BLM FILING FOR YEAR

2012

	<u>CLAIM NAME</u>	<u>AMC#</u>	<u>CLAIM OWNER</u>
40	Abracadabra 10 ✓	350131 ✓	Mary Briggs, et al 2139 W. Elm Phoenix, Az. 85015
41	Abracadabra 11 ✓	350132 ✓	George James, et al 8569 E. Modlock Dr. Glendale, AZ. 85305
42	Abracadabra 12 ✓	350133 ✓	Mary Briggs, et al 2139 W. Elm Phoenix, AZ. 85015
43	Abracadabra 13 ✓	350134	John Abanese, et al
44	Abracadabra 14 ✓	350135	3856 W. Country Gables
45	Abracadabra 15 ✓	350136 ✓	Phoenix, AZ. 85023
46	Abracadabra 16 ✓	350137	Mary Briggs, et al
47	Abracadabra 17 ✓	350138 ✓	2139 W Elm Phoenix, AZ. 85015
48	Abracadabra 18 ✓	350139 ✓	Chris Zollinger, et al 18812 N. 19 th Dr. Phoenix, AZ. 85027
49	Abracadabra 19 ✓	350140 ✓	Mary Briggs, et al 2139 W. Elm Phoenix, AZ. 85015
50	Abracadabra 20 ✓	350141 ✓	Chris Zollinger, et al 18812 N. 19 th Dr. Phoenix, AZ. 85027
51	Abracadabra 21 ✓	350142 ✓	Ron Irvine, et al 7108 W. Mulberry Phoenix, AZ. 85033
52	Bonanza 1 ✓	350330 ✓	Ron Irvine, et al 7108 W. Irvine Phoenix, AZ. 85033

ARIZONA
91-15-16
10/29/16
10/29/16

ARIZONA

BLM FILING FOR YEAR

2012

	CLAIM NAME	AMC#	CLAIM OWNER
53	Calamity 1 ✓	350143 ✓	Jeanne B. Spinella, et al 1747 E. Northern Ave. #150 Phoenix, AZ. 85020
54	Calamity 2 ✓	350144 ✓	Terry Huff, et al 15860 N. 61 st St. Scottsdale, AZ. 85254
55	Calamity 3 ✓	350285	Ron Irvine, et al
56	Calamity 4 ✓	350286 ✓	7108 W. Irvine
57	Calamity 5 ✓	350309	Phoenix, AZ. 85033
58	Calamity 8 ✓	350310	Bruce Austin, et al
59	Calamity 9 ✓	350311 ✓	1714 W. Stottler Dr. Chandler, AZ. 85224
60	Gold Spur #1 ✓	318388 ✓	Richard & Cora Moore 1613 E. Portola Ave. Santa Ana, CA 92701
61	Maybe, Maybe Not ✓	353613	Richard E Conway, et al 3330 E. 1 st St. Tucson, AZ. 85711
62	Wet Rock ✓	353614 ✓	Kathy Homan, et al 9492 E. Caldwell DR. Tucson, AZ. 85747
63	DumbLuck ✓	333347 ✓	Woody Wampler, et al 956 Greenbriar Cr. Mesa, AZ. 85201
64	Bull Tales ✓	353929 ✓	Bud Riley 8228 E. Cypress ST. Scottsdale, AZ. 85257
65	Mighty Find ✓	297243	C.W. (Skip) Merle
66	Square Bear ✓	297244	
67	Little Richer ✓	297245 ✓	
68	Venture II ✓	337791 ✓	

REGISTERED OFFICE

ARIZONA

BLM FILING FOR YEAR

2012

	<u>CLAIM NAME</u>	<u>AMC#</u>	<u>CLAIM OWNER</u>
69	Golden Gobbler ✓	355490 ✓	Bud Riley 8228 E. Cypress ST. Scottsdale, AZ. 85257
70	Pickem up Again ✓	348177 ✓	Ernest L. Leschner, et al
71	Pickem up 1 ✓	304305	48820 N US HWY 60
72	Pickem up 2 ✓	304306	Morristown, AZ 85342
73	Pickem up 3 ✓	304307 ✓	
74	Polaris ✓	342811 ✓	Paul Neff, et al HC 70 Box 5471 Sahuarita, AZ. 85629
75	Hercules ✓	342810 ✓	Paul Neff, et al HC 70 Box 5471 Sahuarita, AZ. 85629
76	Flat Foot ✓	364805 ✓	Dwayne Farmer, et al 5915 Colorada River RD. Blythe, CA. 92225
77	Little Picker ✓	373840	G.P.A.A.
78	Green Grease ✓	373841	Ken Rucker, et al
79	Cat Claw ✓	373842	43445 Business Park Dr #113
80	Oly Pop ✓	373843	Temecula, CA 92590
81	Sarah P ✓	373844	
82	Desert Panner ✓	373845	
83	Baker Inn ✓	373846	
84	The Strut ✓	373847 ✓	
85	Hoppy 1 ✓	371816 ✓	Frank J. Moore, et al
86	Hoppy 2 ✓	371817	3685 W Maulding AVE
87	Hoppy 3 ✓	371818	Las Vegas, NV 89139
88	Hoppy 4 ✓	371819 ✓	
89	Vulture Bait ✓	406412 ✓	Albert L Barton 1505 N La Fresa Dr Goodyear, AZ 85338
90	C-GEM	395798 ✓	James Ebel 14306 Williamsburg St Riverview, MI 48193

ARIZONA

BLM FILING FOR YEAR

2012

<u>CLAIM NAME</u>	<u>AMC#</u>	<u>CLAIM OWNER</u>
91 Gold Planet #2	370752	Russell or Dawn Imeson
92 Royal Gold #6	371201	PO Box 610
93 Gold Bug #1	371371	Afton, WY 83110
94 Get-R-Done #1	367716	
95 Gold Rim #1	371063	
96 Gold Flatz #1 ✓	390613	Brent Gould
97 Gold Flatz #2 ✓	✓390614	17200 West Bell Rd Surprise, AZ 85374
98 SURE FIND ✓	399153	Steve Short
99 YB WORKIN ✓	✓399154	14641 N 90th Lane
100 VENTURE II	✓337791	Peoria, AZ 85381

100 Claims @ \$140 each

Total submitted \$14,000.00

Pay By Credit Card. Authorization Form Attached

By:

Gold Prospectors Association of America

43445 Business Park Dr #113

Temecula, CA 92590

800-551-9707 x153 / x125 Ginger Wimmer / Blake Harmon

RECEIVED
MAY 29 10 12 16
BLM

United States Department of the Interior
Bureau of Land Management
 LANDS/RECREATION & PLANNING
 ONE N CENTRAL AVE
 PHOENIX, AZ 85004 -2203
 Phone: 602-417-9200

Receipt

No: 2421063

Transaction #: 2496497
Date of Transaction: 08/31/2011
CUSTOMER:
GOLD PROSPECTORS ASSOCIATION OF AMERICA 43445 BUSINESS PARK DR STE 113 TEMECULA, CA 92590-3671 US

LINE #	QTY	DESCRIPTION	REMARKS	UNIT PRICE	TOTAL
1	1.00	LOCATABLE MINERALS / MINING CLAIMS-NOT NEW-UNADJUD, ONE AUTH NO. ONLY / MINING CLAIM MONEY RECEIVED CASES: AMC35987/\$14000.00	MAINT FEE PYMNT (100) 2012	- n/a -	14000.00
TOTAL:					\$14,000.00

PAYMENT INFORMATION			
NOTE: Items will appear on credit card statement as "Bureau of Land Mgmt CO".			
1	AMOUNT:	14000.00	POSTMARKED: N/A
	TYPE:	CREDIT CARD	RECEIVED: 08/31/2011
	NAME:	JOHNSON, BRANDON 43445 BUSINESS PARK DR STE 113 TEMECULA CA 92590-3671 US	
	CARD NO:	XXXXXXXXXXXX7501	AUTH CODE: 016397
	NAME ON CARD:	BRANDON JOHNSON	
	EXPIRES:	06/2013	
	SIGNATURE:		

REMARKS

This receipt was generated by the automated BLM Collections and Billing System and is a paper representation of a portion of the official electronic record contained therein.

RZ 10/31/11

\$980 Refund Authorized
PL MFs on 5 closed claims
AMC 370752, AMC 371201, AMC 37137
AMC 367716 & AMC 371063 and
pl ~~MF~~ duplicate MFs on
AMC 337791 & AMC 395798 2011

Authorized Date 11/18/2010

Instructions to Accounts AZ BLM REFUND TO GOLD PROSP ASSOC OF AMERICA \$280 FOR
DUPLICATE PAYMENT OF 2011 MAINT FEES ON AMC390613 AND
390614 AND \$140 2011 MAINT FEE PAID ON CLOSED CLAIM
AMC375427 RECEIPT #2211694 AT

Login ID 2393

Entry Date 11/18/2010

Total Amount \$420.00

Amc 344626

327542

329246

330272

Amc 350285

350309

331449

333855

332360

335768

333387

335192

343903

337776

338212

374071

348413

350282

35987

100714

325932

324198

344407

352316

302602

190993

338375

Amc 390613

370751

371201

371371

367716

371062

397278

342810

364805

373840

371816

375426

350309

318385

353613

341231

333347

353929

297242

337791

355490

348177

304305

342810

350128

350330



Recycled Paper

PLEASE PRESS FIRMLY

Print postage online - Go to usps.

PLI



UNITED STATES POSTAL SERVICE
02 1M \$ 18.30⁰⁰
0004256957 AUG 31 2010
MAILED FROM ZIP CODE 92590



Flat Rate
Mailing Envelope

E

EXPRESS MAIL
EXPRESS MAIL
CORP ACCT



1007

U.S. POSTAGE
PAID
TEMECULA, CA
92591
AUG 31 2010
AMOUNT
\$0.00
00085701-16
(PS Form 3849)

Place Mailing Label Here:

USPS EXPRESS MAIL®

GPAA Shipping Department
43445 Business Park Dr
Ste 113
Temecula CA 92590-3671

Ship Date: 08/31/10

HOW TO USE:



1. Complete Label
Type or print
required information
in customer block.



2. Pay
Affix
upside down
For
Age
appropriate
label

BUREAU OF LAND MANAGEMENT

222 N CENTRAL AVE
PHOENIX AZ 85004-2203

USPS EXPRESS MAIL



EH 0000 0087 5 US

Pick Up
at any Post
office
or items
may be
picked up
at a
pickup
location.



Cradle to Cradle Certification
is awarded to products that
pursue an innovative vision of
ecologically-intelligent design
that eliminates the concept
of waste.
This USPS® packaging has been
certified for its material content,
recyclability, and manufacturing
characteristics.

Please recycle.



ARIZONA
(supplemental)

TIMELY FILED

BLM FILING FOR YEAR

2011

<u>CLAIM NAME</u>	<u>AMC#</u>	<u>CLAIM OWNER</u>
1 Gold Flatz #1	390613	Brent Gould
2 Gold Flatz #2	390614	17200 West Bell Rd Surprise, AZ 85374

2 Claims @ \$140 each
 Total submitted \$280.00
 check # 36376

By:
 Gold Prospectors Association of America
 43445 Business Park Dr. #113
 Temecula, CA 92590
 800-551-9707 x153 Ginger Wimmer

RECEIVED
 BLM AZ STATE OFFICE
 2010 SEP - 3 A 8: 14
 PHOENIX, ARIZONA

NO. OF CLAIMS 98
 AMOUNT 13720
 RECEIPT NO. 2211694
 INIT. SW
 ** BLM-ASO**

one claim closed Amc 375427
 two duplicate payments Amc 390613 and 390614.
 Refunded \$400

ENTERED INTO COMPUTER
 9/20/10 AT

ARIZONA

(supplemental)

BLM FILING FOR YEAR

2011

<u>CLAIM NAME</u>	<u>AMC#</u>	<u>CLAIM OWNER</u>
1 Gold Planet #2	370752	Russell or Dawn Imeson
2 Royal Gold #6	371201	PO Box 610
3 Gold Bug #1	371371	Afton, WY 83110
4 Get-R-Done #1	367716	
5 Gold Rim #1	371063	
6 Vulture Bait	397278	Lester W. Line, ET AL 2050 W. Dunlap Ave Lot C1 Phoenix, AZ 85021-2925

6 Claims @ \$140 each
Total submitted \$840.00
check # 36376

By:
Gold Prospectors Association of America
43445 Business Park Dr. #113
Temecula, CA 92590
800-551-9707 x153 Ginger Wimmer

RECEIVED
BLM AZ STATE OFFICE
2010 SEP - 3 A 8:15
PHOENIX, ARIZONA

ARIZONA

BLM FILING FOR YEAR

2011

	<u>CLAIM NAME</u>	<u>AMC#</u>	<u>CLAIM OWNER</u>
1	Yahoo #2	35987	William Cimino
2	Yahoo #4	100714	P.O. Box 416 Morristown, AZ 85342
3	Golden Dreams #A	325932	John Simpson, et al
4	#1 King Mining	324198	18230 N. 32 Lane Phoenix, AZ 85023
5	Wandering Star	344407	Scott Homan, et al 9492 E. Caldwell Drive Tucson, Az. 85747
6	PC 2	352316	Tom Tierney
7	Big Four #1	302602	P.O. Box 1415
8	Big Four #2	302603	Sierra Vista, AZ 85636
9	Big Four #3	302604	
10	Lost Dutchman	190993	Lost Dutchman Mining Assn. 43445 Business Park Dr #113 Temecula, CA 92590
11	Az Au #1	338375	Gold Prospectors Assn of America
12	Az Au #2	338376	P.O. Box 891509 Temecula, CA 92589-1509
13	Lucky 13	344626	Bob Wilke, et al 8711 W Sierra Vista Drive Glendale, AZ 85305
14	Bahde #10	327542	Clarence Bahde, et al
15	Bahde #11	329246	306 Lakeview
16	Bahde #12	329247	Boulder City, NV 89005
17	Bahde #13	329248	
18	Bahde #14	329249	
19	Bahde #17	330272	
20	Bahde #18	330273	

PHOENIX, ARIZONA
2011 SEP - 3 A 8: 16

RECEIVED
BLM AZ STATE OFFICE

21	Friendship	331449	John Reddoch, et al
22	Lucky Strike	333855	3237 E Holliday Street
23	R Double J	332360	Tucson, AZ 85706
24	Fantastic	335768	
25	Golden Tattoo	333387	
26	Firehouse	335192	James D. Riddenhour, Sr
27	Soldier Boy	343903	3914 N. Hawes
28	Double JJ	343904	Mesa, AZ 85207
29	Gorbert Association	337776	Gordon Howcroft, et al
			19542 Apache Road
			Bend, OR 97702
30	Think It Has	338212	Gilbert Binns, et al
			Box 9000-1578
			Quartzsite, AZ 85346
31	Beau Star	374071	Ken Rucker
			43445 Business Park Drive
			Temecula, CA 92590
32	Abracadabra 1	348413	Kent Reed, et al
33	Abracadabra 2	348414	3426 W. Glen Rosa
34	Abracadabra 3	348415	Phoenix, AZ. 85023
35	Abracadabra 4	348416	
36	Abracadabra 5	350128	Alaric M Woodward, et al
37	Abracadabra 6	350129	2644 W. San Miguel
			Phoenix, AZ. 85017
38	Abracadabra 7	350130	John Albanese, et al
			3856 W. Country Gables Dr.
			Phoenix, AZ. 85027
39	Abracadabra 9	350282	George James, et al
			8569 E. Modlock Dr.
			Glendale, AZ. 85305
40	Abracadabra 10	350131	Mary Briggs, et al
			2139 W. Elm
			Phoenix, Az. 85015
41	Abracadabra 11	350132	George James, et al
			8569 E. Modlock Dr.
			Glendale, AZ. 85305

PHOENIX, ARIZONA

200 SEP - 3 A 8:18

RECEIVED
BLM AZ STATE OFFICE

42	Abracadabra 12	350133	Mary Briggs, et al 2139 W. Elm Phoenix, AZ. 85015
43	Abracadabra 13	350134	John Abanese, et al
44	Abracadabra 14	350135	3856 W. Country Gables
45	Abracadabra 15	350136	Phoenix, AZ. 85023
46	Abracadabra 16	350137	Mary Briggs, et al
47	Abracadabra 17	350138	2139 W Elm Phoenix, AZ. 85015
48	Abracadabra 18	350139	Chris Zollinger, et al 18812 N. 19 th Dr. Phoenix, AZ. 85027
49	Abracadabra 19	350140	Mary Briggs, et al 2139 W. Elm Phoenix, AZ. 85015
50	Abracadabra 20	350141	Chris Zollinger, et al 18812 N. 19 th Dr. Phoenix, AZ. 85027
51	Abracadabra 21	350142	Ron Irvine, et al 7108 W. Mulberry Phoenix, AZ. 85033
52	Bonanza 1	350330	Ron Irvine, et al 7108 W. Irvine Phoenix, AZ. 85033
53	Calamity 1	350143	Jeanne B. Spinella, et al 1747 E. Northern Ave. #150 Phoenix, AZ. 85020
54	Calamity 2	350144	Terry Huff, et al 15860 N. 61 st St. Scottsdale, AZ. 85254
55	Calamity 3	350285	Ron Irvine, et al
56	Calamity 4	350286	7108 W. Irvine
57	Calamity 5	350309	Phoenix, AZ. 85033

2010 SEP - 3 A 8 16
 PHOENIX, ARIZONA

RECEIVED
 BLM AZ STATE OFFICE

58	Calamity 8	350310	Bruce Austin, et al
59	Calamity 9	350311	1714 W. Stottler Dr. Chandler, AZ. 85224
60	Gold Spur #1	318388	Richard & Cora Moore 1613 E. Portola Ave. Santa Ana, CA 92701
61	Maybe, Maybe Not	353613	Richard E Conway, et al 3330 E. 1 st St. Tucson, AZ. 85711
62	Wet Rock	353614	Kathy Homan, et al 9492 E. Caldwell DR. Tucson, AZ. 85747
63	Forlorn	341231	Gary L. Ward, et al P.O. BOX 86 Pine, AZ. 85544
64	DumbLuck	333347	Woody Wampler, et al 956 Greenbriar Cr. Mesa, AZ. 85201
65	Bull Tales	353929	Bud Riley 8228 E. Cypress ST. Scottsdale, AZ. 85257
66	Mighty Find	297243	C.W. (Skip) Merle
67	Square Bear	297244	
68	Little Richer	297245	
69	Venture II	337791	
70	Golden Gobbler	355490	Bud Riley 8228 E. Cypress ST. Scottsdale, AZ. 85257
71	Pickem up Again	348177	Ernest L. Leschner, et al 48820 N US HWY 60 Morristown, AZ 85342
72	Pickem up 1	304305	
73	Pickem up 2	304306	
74	Pickem up 3	304307	
75	Polaris	342811	Paul Neff, et al HC 70 Box 5471 Sahuarita, AZ. 85629

2010 SEP - 3 A 8:15
 PHOENIX, ARIZONA

RECEIVED
 BLM AZ STATE OFFICE

send copy

76	Hercules	342810	Paul Neff, et al HC 70 Box 5471 Sahuarita, AZ. 85629
77	Flat Foot	364805	Dwayne Farmer, et al 5915 Colorada River RD. Blythe, CA. 92225
78	Little Picker	373840	G.P.A.A.
79	Green Grease	373841	Ken Rucker, et al
80	Cat Claw	373842	43445 Business Park Dr #113
81	Oly Pop	373843	Temecula, CA 92590
82	Sarah P	373844	
83	Desert Panner	373845	
84	Baker Inn	373846	
85	The Strut	373847	
86	Hoppy 1	371816	Frank J. Moore, et al
87	Hoppy 2	371817	3685 W Maulding AVE
88	Hoppy 3	371818	Las Vegas, NV 89139
89	Hoppy 4	371819	
90	Apache Chief 1	375427	James Carter 2610 W Vereda Amarillo Tucson, AZ 85746

90 Claims @ \$140 each
 Total submitted \$12,600.00
 check # 36376

By:
 Gold Prospectors Association of America
 43445 Business Park Dr. #113
 Temecula, CA 92590
 800-551-9707 x153 Zinger Wimmer

PHOENIX, ARIZONA

2010 SEP - 3 A 8: 15

RECEIVED
BLM AZ STATE OFFICE

Recycled Paper

Print postage online - Go to usps.

PLEASE PRESS FIRMLY

PLI

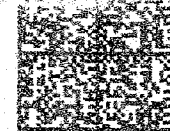

UNITED STATES POSTAL SERVICE
FINEST PAPER
02 1M \$ 18.30⁰⁰
0004256957 AUG 31 2010
MAILED FROM ZIP CODE 92590



UNITED STATES POSTAL SERVICE

Flat Rate Mailing Envelope

E

EXPRESS MAIL
EXPRESS MAIL
CORP ACCT

USPS EXPRESS MAIL®

GPAA Shipping Department
43445 Business Park Dr
Ste 113
Temecula CA 92590-3671

Ship Date: 08/31/10

Place Mailing Label Here:

HOW TO USE:



1. Complete Label
Type or print
required information
in customer block.



2. Pay
Affix
upper
corner
For
Age
acc
label

BUREAU OF LAND MANAGEMENT

222 N CENTRAL AVE
PHOENIX AZ 85004-2203

USPS EXPRESS MAIL

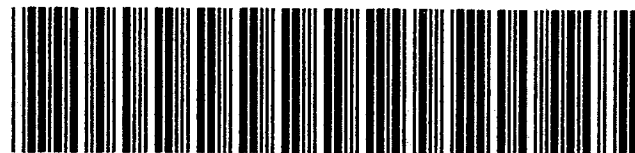

EL 0000 0007 5 10



1007

U.S. POSTAGE
PAID
TEMECULA, CA
92590
AUG 31 10
AMOUNT

\$0.00
00085701-16

(PS FORM 3849)



Cradle to Cradle Certification is awarded to products that pursue an innovative vision of ecologically-intelligent design that eliminates the concept of waste. This USPS® packaging has been certified for its material content, recyclability, and manufacturing characteristics.

Please recycle.

Pick Up at any Post office or items may be picked up at any Post office. Visit usps.com for more information.



United States Department of the Interior
 Bureau of Land Management
 LANDS/RECREATION & PLANNING
 ONE N CENTRAL AVE
 PHOENIX, AZ 85004 -2203
 Phone:

Receipt

No: 2211694

Transaction #: 2281794	
Date of Transaction: 09/09/2010	
CUSTOMER:	
GOLD PROSPECTORS ASSOC OF AMERICA 43445 BUSINESS PARK DR STE 113 TEMECULA, CA 92590-3671 US	

LINE #	QTY	DESCRIPTION	REMARKS	UNIT PRICE	TOTAL
1	1.00	LOCATABLE MINERALS / MINING CLAIMS-NOT NEW-UNADJUD, ONE AUTH NO. ONLY / MINING CLAIM MONEY RECEIVED CASES: AMC390613/\$13720.00	MAINT 2011-98	- n/a -	13720.00
TOTAL:					\$13,720.00

PAYMENT INFORMATION					
1	AMOUNT:	13720.00	POSTMARKED:	N/A	
	TYPE:	CHECK	RECEIVED:	09/09/2010	
	CHECK NO:	36376			
	NAME:	GOLD PROSPECTORS ASSOC OF AMERICA 43445 BUSINESS PARK DR STE 113 TEMECULA CA 92590-3671 US			

REMARKS

This receipt was generated by the automated BLM Collections and Billing System and is a paper representation of a portion of the official electronic record contained therein.

*Refunded \$420.
 Amc 375427 closed
 Amc 390613 and 390614 duplicate payment
 from Brent Gould (claim owner) on # 2000603
 AT*

AMC 327542
329246
330272
331449
333855
332360
335768
333387
335192
343903
337776

374074
348413
350128
350282
350330
350285
350309
318385
353613

353429
297249
337791
297242
355490
348177
304305
324810
364805

AMC 373840
371816
375426
390613
338212
341231

AMC 35987
100714
325932
324198
344407
352316
302602
190993
338375
344626

Enclosed please find our check # 34959, in the

Amount of \$ 12,600⁰⁰, for the 2010 claim

Maintenance Fees for the Mining Claims listed on the

Following page(s).

When recorded, please send documents to

GPAA
43445 Business Park Drive
Temecula, CA 92590

ATTN: Ken, Claims Department.

Or use the enclosed envelope.



Thank You.

RECEIVED
BLM AZ STATE OFFICE
2009 AUG 11 A 8:54
PHOENIX, ARIZONA

ENTERED INTO COMPUTE
8/20/09 DJJ

ARIZONA

<u>CLAIM NAME</u>	<u>AMC#</u>	<u>CLAIM OWNER</u>	<u>ASSESSMENT YR PD FOR</u>
1) Yahoo #2	✓ 35987	William Cimino	2010
2) Yahoo #4	✓ 100714	P.O. Box 416 Morristown, AZ 85342	2010
3) Golden Dreams #A	✓ 325932	John Simpson, ET AL	2010
4) #1 King Mining	✓ 324198	18230 N. 32 Lane Phoenix, AZ 85023	2010
5) Wandering Star	✓ 344407	Scott Homan ET AL 9492 E. Caldwell Drive Tucson, Az. 85747	2010
6) PC 2	✓ 352316		
7) Big Four #1	✓ 302602	Tom Tierney	2010
8) Big Four #2	302603 ✓	P.O. Box 1415	2010
9) Big Four #3	302604 ✓	Sierra Vista, AZ 85636	2010
10) Lost Dutchman	✓ 190993	Lost Dutchman Mining Assn. 43445 Business Park Drive #113 Temecula, CA 92590	2010
11) Az Au #1	✓ 338375	Gold Prospectors Assn of Amer.	2010
12) Az Au #2	338376 ✓	P.O. Box 891509 Temecula, CA 92589-1509	2010
13) Lucky 13	✓ 344626	Bob Wilke, ET AL 8711 W Sierra Vista Drive Glendale, AZ 85305	2010

RECEIVED
BLM AZ STATE OFFICE
2009 AUG 11 A 8:54
PHOENIX, ARIZONA

Enclosed please find our check # 34971, in the
Amount of \$ 290⁰⁰, for the 2010 claim

Maintenance Fees for the Mining Claims listed on the
Following page(s).

When recorded, please send documents to

GPAA
43445 Business Park Drive
Temecula, CA 92590

ATTN: Ken, Claims Department.

Or use the enclosed envelope.

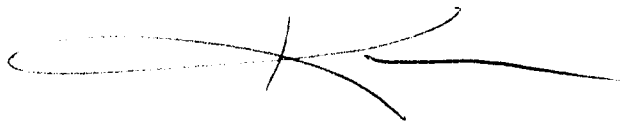

Thank You.

PHOENIX, ARIZONA

2009 AUG 11 A 8:55

RECEIVED
BLM/ARIZONA OFFICE

ARIZONA

<u>CLAIM NAME</u>	<u>AMC#</u>	<u>CLAIM OWNER</u>	<u>ASSESSMENT YR PD FOR</u>
1) Gold Flatz #1	390613	Brent Gould	2010
2) Gold Flatz #2	390614	17200 West Bell Rd Surprise, AZ 85374	2010

RECEIVED
BLM AZ STATE OFFICE
2009 AUG 11 A 8:55
PHOENIX, ARIZONA

ARIZONA (con't)

<u>CLAIM NAME</u>	<u>AMC#</u>	<u>CLAIM OWNER</u>	<u>ASSESSMENT YR PD FOR</u>
14) Bahde #10	∟ 327542	Clarence Bahde, ET AL	2010
15) Bahde #11	∟ 329246	306 Lakeview	2010
16) Bahde #12	329247	Boulder City, NV 89005	2010
17) Bahde #13	329248		2010
18) Bahde #14	329249		2010
19) Bahde #17	∟ 330272		2010
20) Bahde #18	330273		2010
21) Friendship	∟ 331449	John Reddoch, ET AL	2010
22) Lucky Strike	∟ 333855	3237 E Holliday Street	2010
23) R Double J	∟ 332360	Tucson, AZ 85706	2010
24) Fantastic	∟ 335768		2010
25) Golden Tattoo	∟ 333387		2010
26) Firehouse	∟ 335192	James D. Riddenhour, Sr	2010
27) Soldier Boy	∟ 343903	3914 N. Hawes	2010
28) Double JJ	343904	Mesa, AZ 85207	2010
29) Gorbart Association	∟ 337776	Gordon Howcroft, ET AL 19542 Apache Road Bend, OR 97702	2010
30) Think It Has	∟ 338212	Gilbert Binns, ET AL Box 9000-1578 Quartzsite, AZ 85346	2010
31) Beau Star	∟ 374071	Ken Rucker 43445 Business Park Drive Temecula, CA 92590	2010

RECEIVED
DLI
2009 AUG 11 A 8:54

ARIZONA (CON'T)

32)	Abracadabra-1-4	348413	Kent Reed ET AL	2010
33)		348414	3426 W. Glen Rosa	
34)		348415	Phoenix, AZ. 85023	
35)		348416		
36)	Abracadabra 5-6	350128	Alaric M Woodward ET AL	2010
37)		350129	2644 W. San Miguel Phoenix, AZ. 85017	
38)	Abracadabra 7	350130	John Albanese ET AL 3856 W. Country Gables Dr. Phoenix, AZ. 85027	2010
39)	Abracadabra 9	350282	George James ET AL 8569 E. Modlock Dr. Glendale, AZ. 85305	2010
40)	Abracadabra 10	350131	Mary Briggs ET AL 2139 W. Elm Phoenix, Az. 85015	2010
41)	Abracadabra 11	350132	George James ET AL 8569 E. Modlock Dr. Glendale, AZ. 85305	2010
42)	Abracadabra 12	350133	Mary Briggs ET AL 2139 W. Elm Phoenix, AZ. 85015	2010
43)	Abracadabra 13	350134	John Abanese ET AL	2010
44)		350135	3856 W. Country Gables	
45)		350136	Phoenix, AZ. 85023	
46)	Abracadabra 16	350137	Mary Briggs ET AL	2010
47)		350138	2139 W Elm Phoenix, AZ. 85015	
48)	Abracadabra 18	350139	Chris Zollinger ET AL 18812 N. 19 th Dr. Phoenix, AZ. 85027	2010

RECEIVED
2009 AUG 11 A 8:54

ARIZONA (CON'T)

49) Abracadabra 19	350140	Mary Briggs ET AL 2139 W. Elm Phoenix, AZ. 85015	2010
50) Abracadabra 20	350141	Chris Zollinger ET AL 18812 N. 19 th Dr. Phoenix, AZ. 85027	2010
51) Abracadabra 21	350142	Ron Irvine ET AL 7108 W. Mulberry Phoenix, AZ. 85033	2010
52) Bonanza 1	350330	Ron Irvine ET AL 7108 W. Irvine Phoenix, AZ. 85033	2010
53) Calamity 1	350143	Jeanne B. Spinella ET AL 1747 E. Northern Ave. #150 Phoenix, AZ. 85020	2010
54) Calamity 2	350144	Terry Huff ET AL 15860 N. 61 st St. Scottsdale, AZ. 85254	2010
55) Calamity 3	350285	Ron Irvine ET AL	2010
56) Calamity 4	350286	7108 W. Irvine	
57) Calamity 5	350309	Phoenix, AZ. 85033	
58) Calamity 8	350310	Bruce Austin ET AL	2010
59) Calamity 9	350311	1714 W. Stottler Dr. Chandler, AZ. 85224	
60) Gold Spur #1	318388	Richard & Cora Moore 1613 E. Portola Ave. Santa Ana, CA 92701	2010

L
318388

2008 AUG 11 A 8:54
BLM/ASST/STAFF/STAFF

ARIZONA (CON'T)

61) Maybe, Maybe Not	L 353613	Richard E Conway ET AL 3330 E. 1 st St. Tucson, AZ. 85711	2010
62) Wet Rock	353614	Kathy Homan ET AL 9492 E. Caldwell DR. Tucson, AZ. 85747	2010
63) Forlorn	L 341231	Gary L. Ward Et AL P.O. BOX 86 Pine, AZ. 85344	2010
64) DumbLuck	L 333347	Woody Wampler Et Al 956 Greenbriar Cr. Mesa, AZ. 85201	2010
65) Bull Tales	L 353929	Bud Riley 8228 E. Cypress ST. Scottsdale, AZ. 85257	2010
66) Mighty Find	L 297243	C.W. (Skip) Merle	2010
67) Square Bear	297244		
68) Little Richer	297245		
69) Venture II	L 337791		

L
297242

RECEIVED
BIRMINGHAM OFFICE
2001 AUG 11 A 9:54
PHOTOGRAPHY

ARIZONA (CON'T)

70)	Golden Gobbler	L355490 ✓	Bud Riley 8228 E. Cypress ST. Scottsdale, AZ. 85257	2010
71)	Pickem up Again	L348177 ✓	Ernest L. Leschner ET AL	2010
72)	Pickem up 1	L304305 ✓	48820 NUS HWY 60	2010
73)	Pickem up 2	304306 ✓	Morristown, AZ 85342	2010
74)	Pickem up 3	304307		2010
75)	Polaris	342811 ✓	Paul Neff ET AL HC 70 Box 5471 Sahuarita, AZ. 85629	2010
76)	Hercules	L342810 ✓	Paul Neff ET AL HC 70 Box 5471 Sahuarita, AZ. 85629	2010
77)	Flat Foot	L364805 ✓	Dwayne Farmer ET AL 5915 Colorada River RD. Blythe, CA. 92225	2010
78)	L373840	Little Picker	G.P.A.A.	2010
79)	373841	Green Grease	Ken Rucker ET AL	
80)	373842	Cat Claw	43445 Business Park Drive	
81)	373843	Oly Pop	Temecula, CA 92590	
82)	373844	Sarah P		
83)	373845	Desert Panner		
84)	373846	Baker Inn		
85)	373847	The Strut		
86)	L371816	HOPPY 1	Frank J. Moore Et Al	2010
87)	371817	HOPPY 2 ✓	3685 W Maulding AVE	
88)	371818	HOPPY 3	Las Vegas, NV 89139	
89)	371819	HOPPY 4		

2001 AUG 11 V 8:54
ARIZONA
11/17/05

ARIZONA (CON'T)

L
375426

90) 375427 APACHE CHIEF 1

James Carter
2610 W Vereda Amarillo
Tucson, AZ 85746

2010

PHOENIX, ARIZONA

2009 AUG 11 A 8:54

RECEIVED
BLM AZ STATE OFFICE

United States Department of the Interior
Bureau of Land Management
 BUSINESS & SUPPORT SVCS DIV
 ONE N CENTRAL AVE SUITE 800
 PHOENIX, AZ 85004 -4427
 Phone: (602) 417-9200

Receipt

No: 1975258

Transaction #: 2039209	
Date of Transaction: 08/11/2009	
CUSTOMER:	GOLD PROSPECTORS ASSN OF NEV 43445 BUSINES PARK DR #113 TEMECULA, CA 92590 US

LINE #	QTY	DESCRIPTION	REMARKS	UNIT PRICE	TOTAL
1	2.00	LOCATABLE MINERALS / MINING CLAIMS-NOT NEW-UNADJUD, ONE AUTH NO. ONLY / MINING CLAIM MONEY RECEIVED CASES: AMC35987/\$12600.00, AMC390613/\$280.00	MAINT 2010	- n/a -	12880.00
TOTAL:					\$12,880.00

PAYMENT INFORMATION			
1	AMOUNT:	12600.00	POSTMARKED: 08/06/2009
	TYPE:	CHECK	RECEIVED: 08/11/2009
	CHECK NO:	34959	
	NAME:	GOLD PROPECTORS ASSOCIATION OF AMERICA 43445 BUSINES PARK DR #113 TEMECULA CA 92590 US	
2	AMOUNT:	280.00	POSTMARKED: 08/06/2009
	TYPE:	CHECK	RECEIVED: 08/11/2009
	CHECK NO:	34971	
	NAME:	GOLD PROSPECTORS ASSOCIATION OF AMERICA 43445 BUSINES PARK DR #113 TEMECULA CA 92590 US	

REMARKS

This receipt was generated by the automated BLM Collections and Billing System and is a paper representation of a portion of the official electronic record contained therein.

amc 371816

ARIZONA

AMC#	CLAIM OWNER	ASSESSMENT YR PD FOR
1)	371816-371819	2009
371816	HOPPY ①	2009
371817	HOPPY ②	
371818	HOPPY ③	
371819	HOPPY ④	
	371816-371819	

OWNERS

- FRANK J MOORE 3685 W MAULDING AVE LAS VEGAS NEVADA 89139
- PATRICIA MOORE 3685 W MAULDING AVE LAS VEGAS NEVADA 89139
- CHARLEY MOORE #109 2440 SENTRY DRIVE ANCHORAGE AK 99507
- LAURA MOORE #109 2440 SENTRY DRIVE ANCHORAGE AK 99507
- DAVID SCHMIEDER 25810 N 5625 WEST ST MEADVIEW AZ 86444
- SPENCER BRYANT 8612 GRANDBANK DR LAS VEGAS NV 89145
- JAMES MILLER PO BOX 1445 DOLAN SPRINGS AZ 86441
- DONNA McCULLERS 924 HOLLANDSWORTH AVE LAS VEGAS NV 89123

REQUESTED BY KEN RUCKER 951-907-0461 cell phone
OR 1-800-551-9707—X-121

*4 CLAIMS
\$500.00*

I would like to pay the maintenance fees on these by credit card
VISA
Ken L Rucker

RECEIVED
BLM ARIZONA OFFICE
2008 AUG 29 P 1:48

ENTERED INTO COMPUTER

SEP 12 '08 *TSS*

United States Department of the Interior
Bureau of Land Management
 BUSINESS & SUPPORT SVCS DIV
 ONE N CENTRAL AVE SUITE 800
 PHOENIX, AZ 85004 -4427
 Phone: (602) 417-9200

Receipt

No: 1776005

Transaction #: 1833783	
Date of Transaction: 08/29/2008	
CUSTOMER:	FRANK J MOORE 3685 W MAULDING AVE LAS VEGAS,NV 89139

LINE #	QTY	DESCRIPTION	REMARKS	UNIT PRICE	TOTAL
1	1.00	LOCATABLE MINERALS / MINING CLAIMS-NOT NEW-UNADJUD,ONE AUTH NO. ONLY / MINING CLAIM MONEY RECEIVED (455) CASES: AMC371816/\$500.00	2009 MAINT (4)	- n/a -	500.00
TOTAL:					\$500.00

PAYMENT INFORMATION			
NOTE: Items will appear on credit card statement as "Bureau of Land Mgmt CO".			
1	AMOUNT:	\$500.00	POSTMARKED: N/A
	TYPE:	CREDIT CARD	RECEIVED: 08/29/2008
	NAME:	MOORE, FRANK J 3685 W MAULDING AVE LAS VEGAS NV 89139	
	CARD NO:	XXXXXXXXXXXX9759	AUTH CODE: 819230
	NAME ON CARD:	KEN L RUCKER	
	EXPIRES:	12/31/2009	
	SIGNATURE:		

REMARKS

Amc 371917

MAINTENANCE FEE PAYMENT

Claimant Name: BOSILJIC RAY
Address: 15979 N. 76TH ST. SUITE D
City: SCOTTSDALE State: AZ Zip: 85260
Telephone: 480 951 4418
E-mail address: _____
Signature: [Signature]

Check here if this is a change of address.

RECEIVED
BLM AZ STATE OFFICE
2008 SEP - 2 A 7:31
TUCUCLIX, ARIZONA
BLM
Date
Stamp

LINE NO.	AMC NUMBER	CLAIM/SITE NAME	COUNTY RECORDER DATA (If available)	TWP	RNG	SEC
1	371917	AZ IVORY 1				
2	371918	AZ IVORY 2				
3	371919	AZ IVORY 3				
4	371920	AZ IVORY 4				
5	371921	WHITE MARBLE 1				
6	371922	WHITE MARBLE 2				
7	371923	WHITE MARBLE 3				
8	371924	WHITE MARBLE 4				
9	371925	WHITE MARBLE 5				
10	371926	WHITE MARBLE 6				

List additional claims on Form MCF114.

**Bureau of Land Management
Arizona State Office**
www.az.blm.gov

No. of Claims: 6 x \$125 = 2000.⁰⁰
Check No: 6560 Init. [Signature]
Receipt No.: 1777549
For BLM Use Only

Form: MCF112
Revised July 2005

This form is available from the Arizona Department of Mines and Mineral Resources and may be reproduced.

ENTERED INTO COMPUTER
SEP 15 2008 PB

SUPPLEMENTAL ATTACHMENT

May be used with the following forms for listing additional mining claims:

Check One.

- Affidavit of Performance of Annual Work
- Maintenance Fee Payment
- Notice of Intent to Hold Mining Claims
- Notice of Non-Liability for Labor and Materials Furnished

RECEIVED
BLM AZ STATE OFFICE

2008 SEP - 2 A 7: 32
GAVIN, ARIZONA

BLM
Date
Stamp

LINE NO.	AMC NUMBER	CLAIM/SITE NAME	COUNTY RECORDER DATA (If available)	TWP	RNG	SEC
11	371927	WHITE MARBLE 7				
12	371928	WHITE MARBLE 8				
13	371929	WHITE MARBLE 9				
14	371930	WHITE MARBLE 10				
15	371931	WHITE MARBLE 11				
16	371932	WHITE MARBLE 12				

Form MCF114
Revised June 2005



42
cents

US POSTAGE
FIRST-CLASS

STAMPS.COM L20664.15

RECEIVED
BLMAZ STATE OFFICE

2008 SEP -2 A 7:31

PHOENIX, ARIZONA



85004+4427



QUALITY PARK PRODUCTS
24529

United States Department of the Interior
Bureau of Land Management
 BUSINESS & SUPPORT SVCS DIV
 ONE N CENTRAL AVE SUITE 800
 PHOENIX, AZ 85004 -4427
 Phone: (602) 417-9200

Receipt

No: 1777549

Transaction #: 1835392	
Date of Transaction: 09/02/2008	
CUSTOMER:	RAY BOSILCIC 15979 N 76TH ST STE.D SCOTTSDALE,AZ 85260

LINE #	QTY	DESCRIPTION	REMARKS	UNIT PRICE	TOTAL
1	1.00	LOCATABLE MINERALS / MINING CLAIMS-NOT NEW-UNADJUD,ONE AUTH NO. ONLY / MINING CLAIM MONEY RECEIVED (455) CASES: AMC371917/\$2000.00	MAINT 2009	- n/a -	2000.00
TOTAL:					\$2,000.00

PAYMENT INFORMATION					
1	AMOUNT:	\$2,000.00	POSTMARKED:	8/28/08 0:00	
	TYPE:	CHECK	RECEIVED:	09/02/2008	
	CHECK NO:	6560			
	NAME:	STONEWORLD INC. 15979 N 76TH ST STE.D SCOTTSDALE AZ 85260			

REMARKS

This receipt was generated by the automated BLM Collections and Billing System and is a paper representation of a portion of the official electronic record contained therein.

P-27-07

ENCLOSED PAYMENT

FOR HOPPY #1-4
AMC 371816-819

MAINTENANCE FEE

FOR 2008

Thank You

FRANK J. MOORE
3685 W. MAULDING AV
L.V., NV. 89139

AMC 371816

United States Department of the Interior
 Bureau of Land Management
 BUSINESS & SUPPORT SVCS DIV
 ONE N CENTRAL AVE SUITE 800
 PHOENIX, AZ 85004 -4427
 Phone: (602) 417-9200

Receipt

No:

1557622

Transaction #: 1609258	
Date of Transaction: 08/30/2007	
CUSTOMER:	FRANK J MOORE 3685 W MAULDING AVE LAS VEGAS,NV 89139
ENTERED INTO COMPUTER SEP 13 2007 <i>FB</i> +Verified	

LINE #	QTY	DESCRIPTION	REMARKS	UNIT PRICE	TOTAL
1	1.00	LOCATABLE MINERALS / MINING CLAIMS-NOT NEW-UNADJUD,ONE AUTH NO. ONLY / MINING CLAIM MONEY RECEIVED (455) CASES: AMC371816/\$500.00	MAINT 2008 (4)	- n/a -	500.00
TOTAL:					\$500.00

PAYMENT INFORMATION					
1	AMOUNT:	\$500.00	POSTMARKED:	8/27/07 0:00	
	TYPE:	CHECK	RECEIVED:	08/30/2007	
	CHECK NO:	4575			
	NAME:	MOORE, FRANK J 3685 W MAULDING AVE LAS VEGAS NV 89139			

REMARKS

This receipt was generated by the automated BLM Collections and Billing System and is a paper representation of a portion of the official electronic record contained therein.

AMC 371816

UNITED STATES
DEPARTMENT OF THE INTERIOR
BUREAU OF LAND MANAGEMENT

CREDIT CARD PAYMENT
FOR MINING CLAIM MAINTENANCE FEE

NAME FRANK J. MOOTE ASSOCIATION

ADDRESS 3685 W. MAULDING AVE

CITY LAS VEGAS STATE NV ZIP 89139

PHONE # (702) 897-6729

SEND RECEIPT TO ABOVE ADDRESS

SEND RECEIPT TO: _____

AMC NUMBER

371816-819

CLAIM/SITE NAME

HOPPY # 1-4

DATE STAMP

TELEPHONE SUBMISSION - ACCURACY OF THE ABOVE INFORMATION
IS THE RESPONSIBILITY OF THE CLAIMANT/OWNER

FOR OFFICIAL USE ONLY

DATE _____ INITIALS _____ VERIFIED _____

COUNT 4 \$ 500⁰⁰ INITIALS SC

RECEIVED
B.L.M. AZ STATE OFFICE

2006 AUG 17 A 11: 20

PHOENIX, ARIZONA

United States Department of the Interior
Bureau of Land Management
 BUSINESS & SUPPORT SVCS DIV
 ONE N CENTRAL AVE
 PHOENIX, AZ 85004 -2203
 Phone: (602) 417-9200

Receipt

No: 1342255

Transaction #: 1387478		ENTERED INTO COMPUTER AUG 28 2006 PB
Date of Transaction: 08/23/2006		
CUSTOMER:	FRANK J MOORE 3685 W MAULDING AVE LAS VEGAS, NV 89139	

LINE #	QTY	DESCRIPTION	REMARKS	UNIT PRICE	TOTAL
1	4.00	LOCATABLE MINERALS / MINING CLAIMS-NOT NEW-UNADJUD, ONE AUTH NO. ONLY / MINING CLAIM MONEY RECEIVED (455) CASES: AMC371816/\$125.00, AMC371817/\$125.00, AMC371818/\$125.00, AMC371819/\$125.00	MAINT 2007 (4)	- n/a -	500.00
TOTAL:					\$500.00

PAYMENT INFORMATION			
NOTE: Items will appear on credit card statement as "Bureau of Land Management".			
1	AMOUNT:	\$500.00	POSTMARKED: N/A
	TYPE:	CREDIT CARD	RECEIVED: 08/23/2006
	NAME:	MOORE, FRANK J 3685 W MAULDING AVE LAS VEGAS NV 89139	
	CARD NO:	XXXXXXXXXXXX6168	AUTH CODE: 033461
	NAME ON CARD:	FRANK J MOORE	
	EXPIRES:	07/31/2008	
	SIGNATURE:		

REMARKS

This receipt was generated by the automated BLM Collections and Billing System and is a paper representation of a portion of the official electronic record contained therein.

NOTICE!!

These documents have been scanned!

Do not place un-scanned documents beneath this notice!

Do not remove this notice from this file!

GPO Jacket No. 560-102
Print Order 61540
Rise Business Services, LLC
Job=AZ15 5/30/2019



Box Number= AZ15104



Claim Begin-End: AMC371816-AMC371819

5 Miscellaneous



AZ15104-10

AMC371533-AMC371978

**NO
DOCUMENTS
FOUND**

NO DOCUMENTS FOUND
NO DOCUMENTS FOUND

NOTICE!!

These documents have been scanned!

Do not place un-scanned documents beneath this notice!

Do not remove this notice from this file!

GPO Jacket No. 560-102
Print Order 61540
Rise Business Services, LLC
Job=AZ15 5/30/2019



Box Number= AZ15104



Claim Begin-End: AMC371816-AMC371819

6 Location Notices-Amendments and Supporting Documents



AZ15104-10

AMC371533-AMC371978

MINING CLAIM STATUS REPORT

STATUS:
MTP CHECKED BY _____
GEO CHECKED BY _____

LEAD SERIAL NO. AMC 371816 THROUGH AMC 371819

# _____	LODE	LOCATION FEE @ \$30 =	\$ <u>120.-</u>
# _____	PLACER	PROCESSING FEE @ \$15 =	\$ <u>60.-</u>
# <u>4</u>	ASSOCIATION PL	MAINTENANCE FEE @ \$125 =	\$ <u>500.⁰⁰</u>
# _____	MILL SITE	OVERAGE	\$ _____
# _____	TUNNEL SITE	SHORTAGE	\$ _____
		OTHER FEES	\$ _____
		TOTAL	\$ <u>680.⁰⁰</u>

OVER-THE-COUNTER [] MAIL [] TIMELY FILED: YES [] NO []

LEGAL DESCRIPTION: T 29N R 18W SEC 26
T _____ R _____ SEC _____
T _____ R _____ SEC _____
T _____ R _____ SEC _____

BLM [] FOREST SERVICE [] _____ SUBJ TO PL 359: YES [] NO []

WILDERNESS AREA: NO [] YES [] _____

SPLIT ESTATE: SX [] PX [] SRHA [] OTHER [] _____ N/A []
PROPER NOTICE FILED IF LOCATED ON SRHA LANDS-YES [] NO [] N/A []

RECONVEYED MINERALS ON BLM LANDS REQUIRE OPENING ORDERS
FROM 1944 TO 1993. OPEN TO ENTRY ON: _____ N/A []

STATUS; VOID [] PARTIALLY VOID [] PRIVATE MINERALS []
WITHDRAWN LANDS [] OTHER [] _____

CLAIMANT ACKNOWLEDGES THAT PORTIONS OF THE CLAIM(S) MAY BE
VOID OR VOIDABLE. Claimant Signature: _____

COMMENTS:

FINAL ADJUDICATION AB 6/28/06

Official Receipt
Mohave County Recorder's Office
 Joan McCall, Recorder
 700 W Beale Street
 P.O. Box 70
 Kingman, AZ 86402
 (928) 753-0701

Receipt: 320820

Product Name	Quantity	Unit Price	Extended
MINE Notice of Mining Claim Location Start# 2006045558, End# 2006045561, Book/Page: B:6242 P:640, B:6242 P:643, B:6242 P:646, B:6242 P:649, # Pages 3, Paid By: FRANK J MOORE & ASSOC FRANK J MOORE & ASSOC FRANK J MOORE & ASSOC FRANK J MOORE & ASSOC	4	\$14.00	\$56.00
COPY Copy Copies 12, Certified Copies 0, Conformed Copies 0, Paid By frank j moore & assoc	1	\$12.00	\$12.00

Total \$68.00
 Tender (Cash) \$100.00
 Change (Cash) (\$32.00)

AMG 371818

RECEIVED
 B.L.M. AZ STATE OFFICE
 2006 MAY - 8 P 2: 01
 PHOENIX, ARIZONA

Thank you!
 Wed May 03 10:22:09 MST 2006 by gregol

3

When recorded, mail to:

Name: FRANK MOORE

Address: 3685 W. MAULDING AVE

City/State/Zip Code: LAS VEGAS NV 89139



PAGE: 1 of 3 FEE # 2006045558

B: 6242 P: 640

OFFICIAL RECORDS
OF MOHAVE COUNTY
JOAN MCCALL,
COUNTY RECORDER



5/3/06 10:22 AM Fee: \$14.00
DOC TYPE: MINE
PAID BY: FRANK J MOORE & ASSOC

Space above this line for Recorder's use

NOTICE OF MINING CLAIM

1. TYPE OF NOTICE: Location Amendment Relocation
2. TYPE OF CLAIM: Placer Lode Millsite Tunnelsite
3. The name and address of the Locator is
Name: FRANK J. MOORE AND ASSOCIATION
Address: 3685 W. MAULDING AVE.
City/State/Zip Code: LAS VEGAS NV 89139
4. The name of the claim is HOPPY 1
5. The date of the location is 5-3-06
6. The claim is 2640 feet long and 2640 feet wide. The distance from the location monument to each end of the claim is 2639 feet in a NORTH direction and 2639 feet in a WEST direction.
7. The general course of the claim is from the _____ to the _____
8. The location of the claim is in Section 26 NW 1/4, Township 29 N Range 18 W, _____ Mining District, _____ County, State of ARIZONA.
GILA SALT RIVER Base and Meridian
9. If amending or relocating, the previous claim name was _____ recorded in Docket(Book) _____ page(s) _____ Mining District, _____ County, State of _____.
10. The location of the claim with reference to a natural object or permanent monument is _____

Dated: 05-03-06

Frank J Moore
Signature
3685 W. MAULDING AVE.
Address
LAS VEGAS NV 89139
City/State/Zip

PHOENIX, ARIZONA

2006 MAY -8 P 2:02

RECEIVED
B.L.M. AZ STATE OFFICE

AMC 371916

MAP OF MINING CLAIM LOCATION

1. The name of the claim is HOPPY 1 ;
2. The _____ corner of the claim is _____ feet in a _____ direction to a survey monument or permanent natural object described as _____ ;
3. The type of location monument is WOOD POST ;
The type of corner end monuments are USGS SURVEY MONUMENT ;
4. The bearing and distance between the corners of the claim are beginning at the NW corner of the claim, 2640 feet in a EAST direction to the NE corner, then 2640 feet in a South direction to the SE corner, then 2640 feet in a WEST direction to the SW corner, then 2640 feet in a NORTH direction to the point of beginning.

MAP

One inch = One thousand feet

North Arrow



ONE MILE

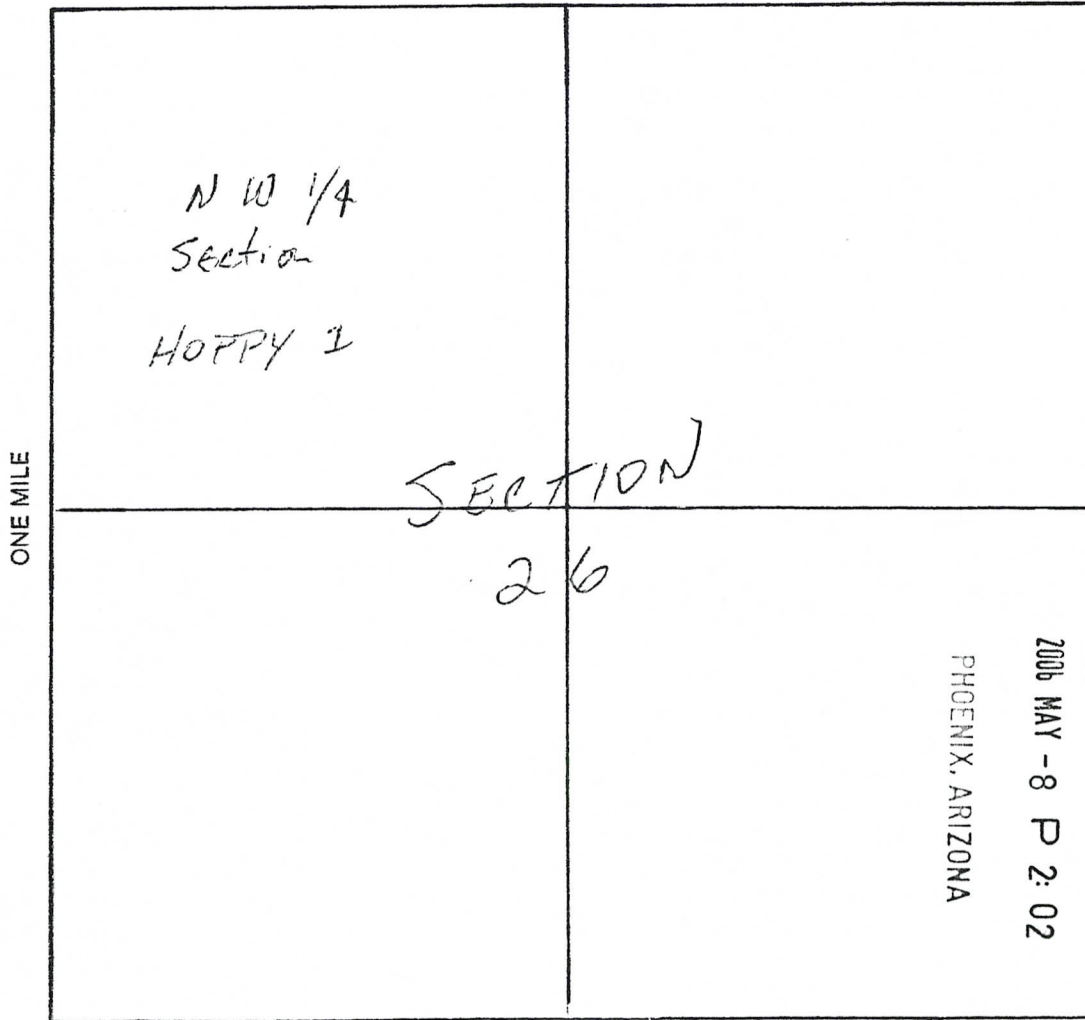

AMC 371816

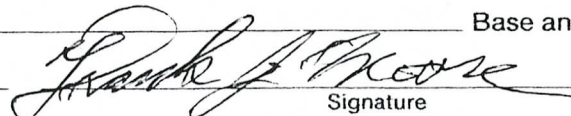
Section 26 Range 18 W Township 29 N ,
(14) GILA SALT RIVER Base and Meridian.
 Dated: 05-03-04  Signature

ADDENDUM TO ASSOCIATION PLACER MINING CLAIM'S

Claim Name's: HOPPY 1, HOPPY 2, HOPPY 3, HOPPY 4

Geographic Location's: N.W. ¼ of Section 26, Twp. 29 N., Range 18 W.
S.W. ¼ of Section 26, Twp. 29 N., Range 18 W.
S.E. ¼ of Section 26, Twp. 29 N., Range 18 W.
N.E. ¼ of Section 26, Twp. 29 N., Range 18 W.

Location Date: _____

Associate Locators as follows:

Frank J. Moore	3685 W. Maulding Ave. Las Vegas, NV 89139
Patrica A. Moore	3685 W. Maulding Ave. Las Vegas, NV 89139
Charley L. Moore	#109 2440 Sentry Dr. Anchorage, AK 99507
Laura Moore	#109 2440 Sentry Dr. Anchorage, AK 99507
Dave Schmieder	25810 N 5625 West Street, Meadview, AZ 86444
Spencer Bryant	8612 Grandbank Dr., Las Vegas, NV 89145
James Miller	PO Box 1445 Dolan Springs, Arizona, 86441
Donna J. McCullers	924 Hollandsworth Ave. Las Vegas, NV 89123

PHOENIX, ARIZONA

2006 MAY - 8 P 2: 02

RECEIVED
B.L.M. AZ STATE OFFICE

AMC 371816

3

When recorded, mail to:

Name: FRANK MOORE

Address: 3685 W MAULDING AVE

City/State/Zip Code: LAS VEGAS NV 89139



PAGE: 1 of 3 FEE # 2006045559

B:6242 P:643

OFFICIAL RECORDS
OF MOHAVE COUNTY
JOAN MCCALL,
COUNTY RECORDER



5/3/06 10:22 AM Fee: \$14.00
DOC TYPE: MINE
PAID BY: FRANK J MOORE & ASSOC

Space above this line for Recorder's use

NOTICE OF MINING CLAIM

1. TYPE OF NOTICE: Location Amendment Relocation
2. TYPE OF CLAIM: Placer Lode Millsite Tunnelsite
3. The name and address of the Locator is
Name: FRANK J. MOORE AND ASSOCIATS
Address: 3685 W. MAULDING AVE
City/State/Zip Code: LAS VEGAS NV 89139
4. The name of the claim is HOPPY 2
5. The date of the location is 05-03-06
6. The claim is 2640 feet long and 2640 feet wide. The distance from the location monument to each end of the claim is 2639 feet in a WEST direction and 2639 feet in a SOUTH direction.
7. The general course of the claim is from the _____ to the _____
8. The location of the claim is in Section 26 SW 1/4, Township 29 N, Range 18 W, GILA SALT RIVER Base and Meridian, _____ Mining District, MOHAVE County, State of ARIZONA.
9. If amending or relocating, the previous claim name was _____ recorded in Docket(Book) _____ page(s) _____ Mining District, _____ County, State of _____.
10. The location of the claim with reference to a natural object or permanent monument _____

Dated: 05-03-06

Frank J Moore
Signature
3685 W. MAULDING AVE
Address
LAS VEGAS NV 89139
City/State/Zip

RECEIVED
BLM. AZ STATE OFFICE
2006 MAY - 8 P 2:02
PHOENIX, ARIZONA

AMC 371817

MAP OF MINING CLAIM LOCATION

1. The name of the claim is HOPPY 2 ;
2. The _____ corner of the claim is _____ feet in a _____ direction to a survey monument or permanent natural object described as _____ ;
3. The type of location monument is WOOD POST ;
The type of corner end monuments are USGS SURVEY MONUMENT ;
4. The bearing and distance between the corners of the claim are beginning at the NE corner of the claim, 2640 feet in a WEST direction to the NW corner, then 2640 feet in a SOUTH direction to the SW corner, then 2640 feet in a EAST direction to the SE corner, then 2640 feet in a NORTH direction to the point of beginning.

MAP

One inch = One thousand feet

North Arrow



ONE MILE

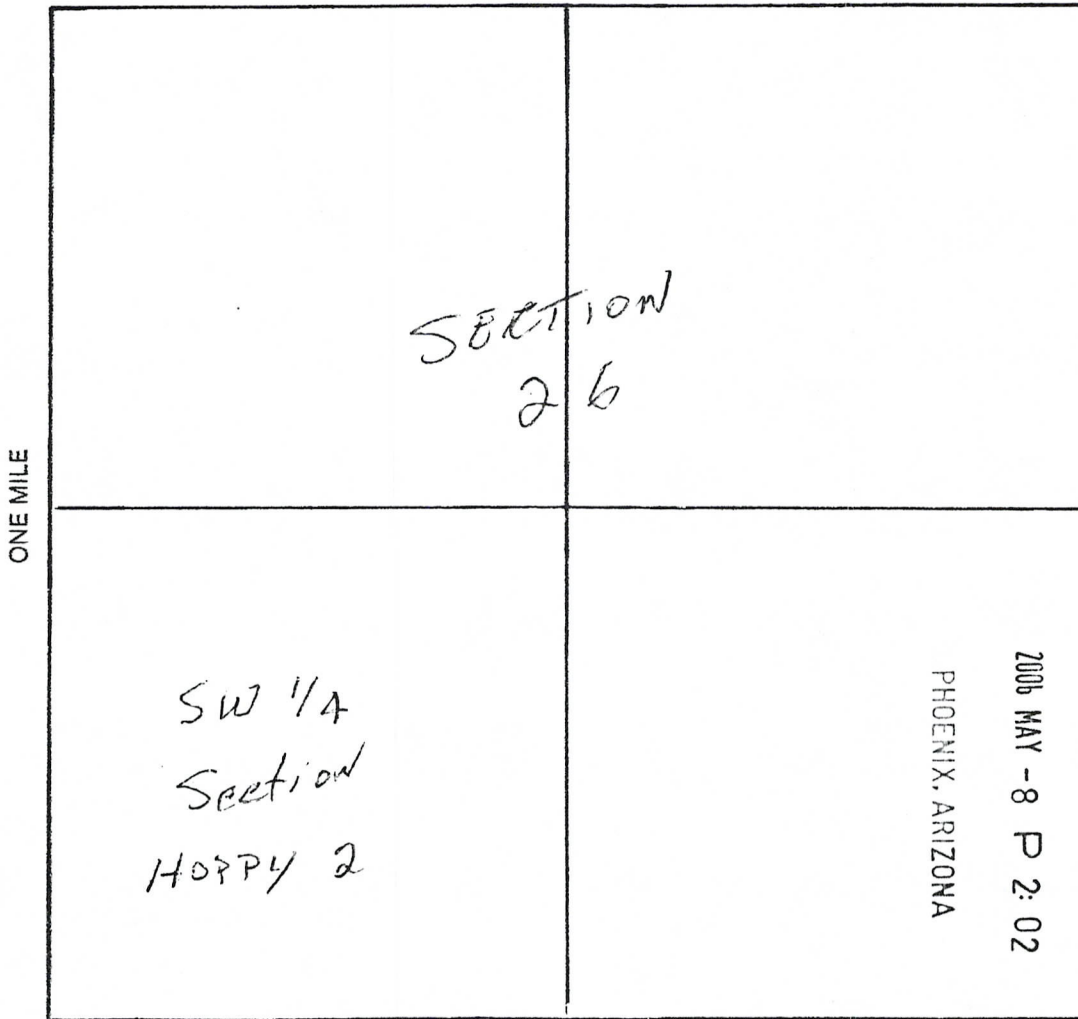

AMC 371817

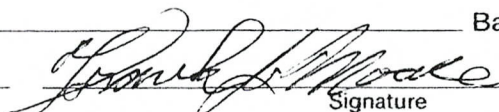
Section 26 Range 18 W Township 29 N ,
(14) CILIA SALT RIVER Base and Meridian.
 Dated: 05-03-04  Signature

ADDENDUM TO ASSOCIATION PLACER MINING CLAIM'S

Claim Name's: HOPPY 1, HOPPY 2, HOPPY 3, HOPPY 4

Geographic Location's: N.W. ¼ of Section 26, Twp. 29 N., Range 18 W.
S.W. ¼ of Section 26, Twp. 29 N., Range 18 W.
S.E. ¼ of Section 26, Twp. 29 N., Range 18 W.
N.E. ¼ of Section 26, Twp. 29 N., Range 18 W.

Location Date: _____

Associate Locators as follows:

Frank J. Moore	3685 W. Maulding Ave. Las Vegas, NV 89139
Patrica A. Moore	3685 W. Maulding Ave. Las Vegas, NV 89139
Charley L. Moore	#109 2440 Sentry Dr. Anchorage, AK 99507
Laura Moore	#109 2440 Sentry Dr. Anchorage, AK 99507
Dave Schmieder	25810 N 5625 West Street, Meadview, AZ 86444
Spencer Bryant	8612 Grandbank Dr., Las Vegas, NV 89145
James Miller	PO Box 1445 Dolan Springs, Arizona, 86441
Donna J. McCullers	924 Hollandsworth Ave. Las Vegas, NV 89123

RECEIVED
B.L.M. AZ STATE OFFICE
2006 MAY -8 P 2:02
PHOENIX, ARIZONA

AMG 371817

3

When recorded, mail to:

Name: FRANK MOORE

Address: 3685 W. MAULDING AVE

City/State/Zip Code: LAS VEGAS NV 89139



PAGE: 1 of 3 FEE # 2006045560

B:6242 P:646

OFFICIAL RECORDS
OF MOHAVE COUNTY
JOAN MCCALL,
COUNTY RECORDER



5/3/06 10:22 AM Fee: \$14.00

DOC TYPE: MINE

PAID BY: FRANK J MOORE & ASSOC

Space above this line for Recorder's use

NOTICE OF MINING CLAIM

1. TYPE OF NOTICE: Location Amendment Relocation

2. TYPE OF CLAIM: Placer Lode Millsite Tunnelsite

3. The name and address of the Locator is

Name: FRANK J. MOORE AND ASSOCIATS

Address: 3685 W. MAULDING AVE

City/State/Zip Code: LAS VEGAS NV 89139

4. The name of the claim is HOPPY 3

5. The date of the location is 05-03-06

6. The claim is 2640 feet long and 2640 feet wide. The distance from the location monument to each end of the claim is 2639 feet in a EAST direction and 2639 feet in a SOUTH direction.

7. The general course of the claim is from the _____ to the _____

8. The location of the claim is in Section 26 SE 1/4, Township 29 N, Range 18 W

GILA SALT RIVER Base and Meridian,

_____ Mining District, MOHAVE County,

State of ARIZONA

9. If amending or relocating, the previous claim name was _____

_____ recorded in Docket(Book) _____ page(s) _____

_____ Mining District, _____ County,

State of _____

10. The location of the claim with reference to a natural object or permanent monument _____

Dated: 05-03-06

Frank J. Moore
Signature
3685 W. MAULDING AVE.
Address

LAS VEGAS NV 89139
City/State/Zip

RECEIVED
B.L.M. AZ STATE OFFICE
2006 MAY - 8 P 2:02
PHOENIX, ARIZONA

AMC 371818

MAP OF MINING CLAIM LOCATION

1. The name of the claim is HOPPY 3 ;
2. The _____ corner of the claim is _____ feet in a _____ direction to a survey monument or permanent natural object described as _____ ;
3. The type of location monument is WOOD POST ;
The type of corner end monuments are USGS SURVEY MONUMENT ;
4. The bearing and distance between the corners of the claim are beginning at the NW corner of the claim, 2640 feet in a EAST direction to the NE corner, then 2640 feet in a SOUTH direction to the SE corner, then 2640 feet in a WEST direction to the SW corner, then 2640 feet in a NORTH direction to the point of beginning.

MAP

One inch = One thousand feet

North Arrow



ONE MILE

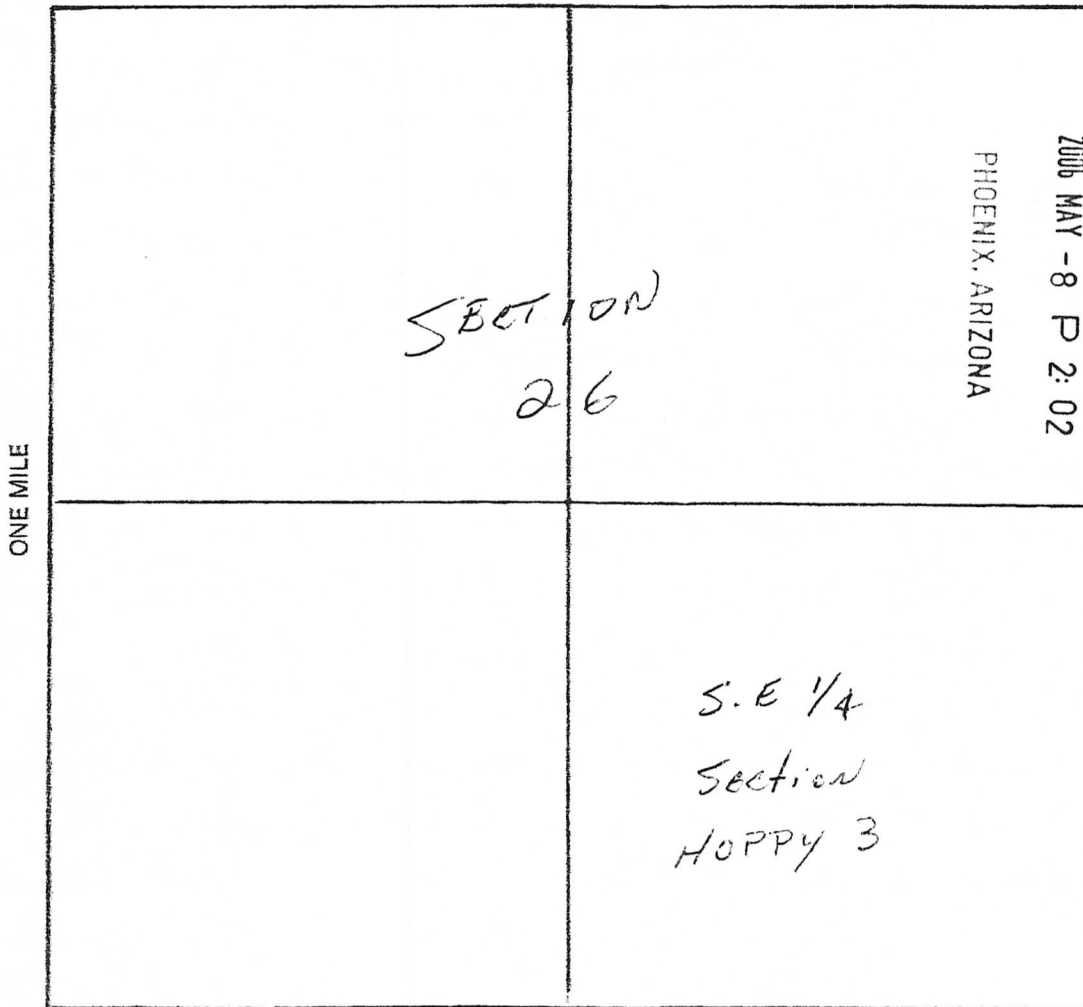

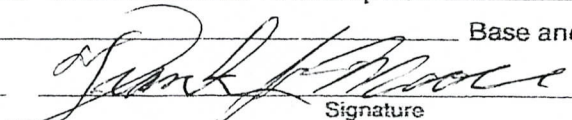
Section 26 Range 18 W Township 29 N
(14) GILA SALT RIVER Base and Meridian.
 Dated: 05-03-06  Signature

ADDENDUM TO ASSOCIATION PLACER MINING CLAIM'S

Claim Name's: HOPPY 1, HOPPY 2, HOPPY 3, HOPPY 4

Geographic Location's: N.W. ¼ of Section 26, Twp. 29 N., Range 18 W.
S.W. ¼ of Section 26, Twp. 29 N., Range 18 W.
S.E. ¼ of Section 26, Twp. 29 N., Range 18 W.
N.E. ¼ of Section 26, Twp. 29 N., Range 18 W.

Location Date: _____

Associate Locators as follows:

Frank J. Moore	3685 W. Maulding Ave. Las Vegas, NV 89139
Patrica A. Moore	3685 W. Maulding Ave. Las Vegas, NV 89139
Charley L. Moore	#109 2440 Sentry Dr. Anchorage, AK 99507
Laura Moore	#109 2440 Sentry Dr. Anchorage, AK 99507
Dave Schmieder	25810 N 5625 West Street, Meadview, AZ 86444
Spencer Bryant	8612 Grandbank Dr., Las Vegas, NV 89145
James Miller	PO Box 1445 Dolan Springs, Arizona, 86441
Donna J. McCullers	924 Hollandsworth Ave. Las Vegas, NV 89123

PHOENIX, ARIZONA

2006 MAY - 8 P 2: 02

RECEIVED
B.L.M. AZ STATE OFFICE

AMC 371818

3



B:6242 P:649



OFFICIAL RECORDS OF MOHAVE COUNTY JOAN MCCALL, COUNTY RECORDER

5/3/06 10:22 AM Fee: \$14.00 DOC TYPE: MINE PAID BY: FRANK J MOORE & ASSOC

When recorded, mail to:

Name: FRANK MOORE

Address: 3685 W MAULDING AVE

City/State/Zip Code: LAS VEGAS NV 89139

Space above this line for Recorder's use

NOTICE OF MINING CLAIM

- 1. TYPE OF NOTICE: Location Amendment Relocation
- 2. TYPE OF CLAIM: Placer Lode Millsite Tunnelsite
- 3. The name and address of the Locator is
 Name: FRANK J. MOORE AND ASSOCIATION
 Address: 3685 W. MAULDING AVE
 City/State/Zip Code: LAS VEGAS NV 89139
- 4. The name of the claim is HOPPY A
- 5. The date of the location is 05-03-06
- 6. The claim is 2640 feet long and 2640 feet wide. The distance from the location monument to each end of the claim is 2639 feet in a NORTH direction and 2639 feet in a EAST direction.
- 7. The general course of the claim is from the _____ to the _____
- 8. The location of the claim is in Section 26 NE 1/4, Township 29 N, Range 18 W, GILA SALT RIVER Base and Meridian, _____ Mining District, MOHAVE County, State of ARIZONA.
- 9. If amending or relocating, the previous claim name was _____ recorded in Docket(Book) _____ page(s) _____ Mining District, _____ County, State of _____.
- 10. The location of the claim with reference to a natural object or permanent monument is _____

Dated: 05-03-06

Signature: Frank Moore
Address: 3685 W. MAULDING AVE

City/State/Zip: LAS VEGAS NV 89139

RECEIVED B.L.M. ARIZONA STATE OFFICE 2006 MAY -8 P 2:01 PHOENIX ARIZONA

AMC 371819

MAP OF MINING CLAIM LOCATION

- The name of the claim is HOPPY 4 ;
- The _____ corner of the claim is _____ feet in a _____ direction to a survey monument or permanent natural object described as _____ ;
- The type of location monument is WOOD POST ;
The type of corner end monuments are USGS SURVEY MONUMENT ;
- The bearing and distance between the corners of the claim are beginning at the SW corner of the claim, 2640 feet in a NORTH direction to the N.W. corner, then 2640 feet in a EAST direction to the NE corner, then 2640 feet in a SOUTH direction to the S.E. corner, then 2640 feet in a WEST direction to the point of beginning.

MAP

One inch = One thousand feet

North Arrow



ONE MILE

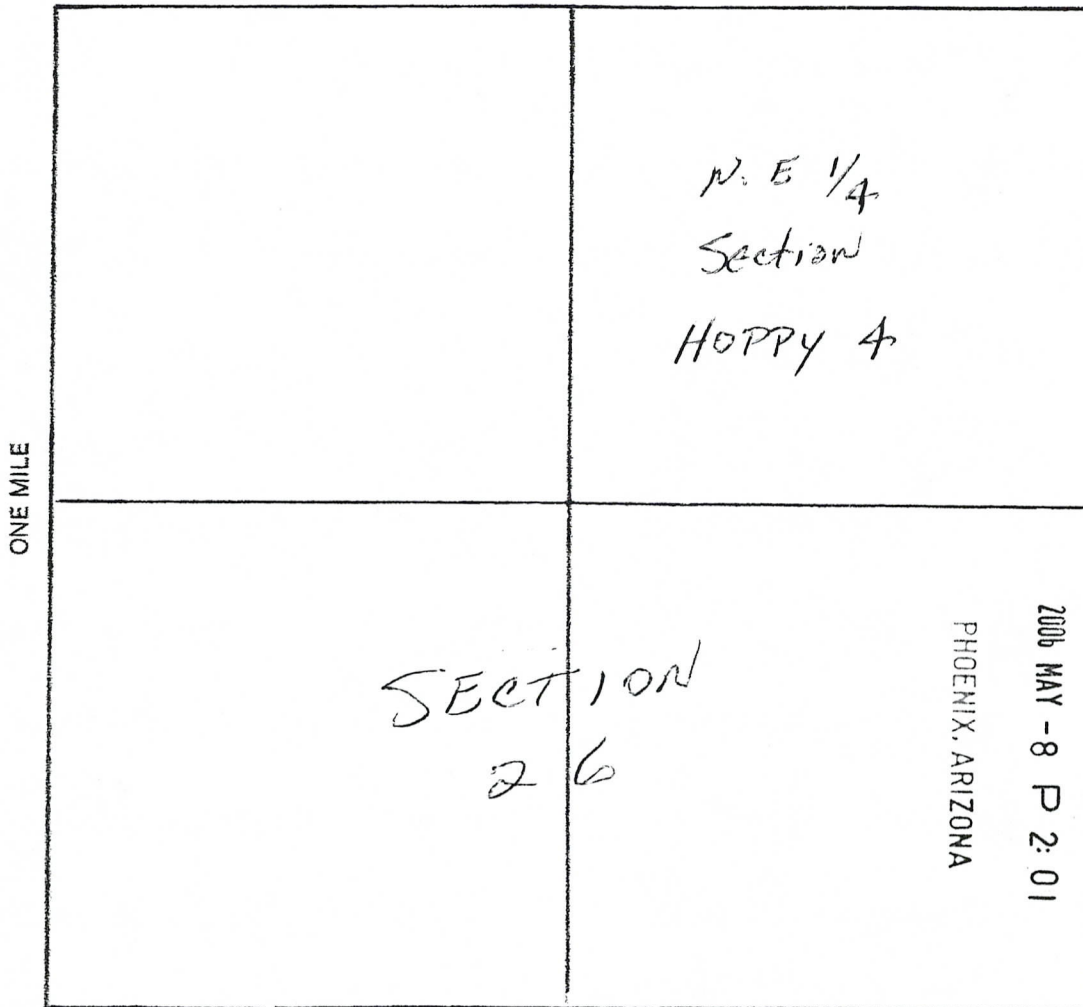

RECEIVED
640 ACRES B.L.M. AZ STATE OFFICE

AMC 371819

Section 26 Range 13 W Township 29 N
(14) GILA SALT RIVER Base and Meridian.
 Dated: 05-03-04 Signature Frank P. Brown

ADDENDUM TO ASSOCIATION PLACER MINING CLAIM'S

Claim Name's: HOPPY 1, HOPPY 2, HOPPY 3, HOPPY 4

Geographic Location's: N.W. ¼ of Section 26, Twp. 29 N., Range 18 W.
S.W. ¼ of Section 26, Twp. 29 N., Range 18 W.
S.E. ¼ of Section 26, Twp. 29 N., Range 18 W.
N.E. ¼ of Section 26, Twp. 29 N., Range 18 W.

Location Date: _____

Associate Locators as follows:

Frank J. Moore	3685 W. Maulding Ave. Las Vegas, NV 89139
Patrica A. Moore	3685 W. Maulding Ave. Las Vegas, NV 89139
Charley L. Moore	#109 2440 Sentry Dr. Anchorage, AK 99507
Laura Moore	#109 2440 Sentry Dr. Anchorage, AK 99507
Dave Schmieder	25810 N 5625 West Street, Meadview, AZ 86444
Spencer Bryant	8612 Grandbank Dr., Las Vegas, NV 89145
James Miller	PO Box 1445 Dolan Springs, Arizona, 86441
Donna J. McCullers	924 Hollandsworth Ave. Las Vegas, NV 89123

PHOENIX, ARIZONA

2006 MAY - 8 P 2: 01

RECEIVED
B.L.M. AZ STATE OFFICE

AMC 371819

Input Parameters for Geographic Report with Land

System Id = CR

Admin State = AZ

Geo State = AZ

Casetype Begins With

Case Disp Txt = AUTHORIZED, CANCELLED, EXPIRED, PENDING, REJECTED, RELINQUISHED, WITHDRAWN

Mer Twp Rng =

Section =

Mtrs = 14 0290N 0180W 026

Commodity =

Commodity Txt =

Pending Org =

Pend Org Decode =

Total Rows Returned: 2

RUN TIME: 09:22 AM

Adm State: AZ

UNITED STATES DEPARTMENT OF INTERIOR
BUREAU OF LAND MANAGEMENT
GEOGRAPHIC REPORT WITH LAND
Sorted by Meridian Township Range

RUN DATE: 06/19/2006
Page 1 of 1

Serial Number: AZA 022836

Total Case Acres: 64.030

<u>Casetype</u>	<u>Case Disp</u>			<u>Sect</u>	<u>Sur Typ</u>	<u>Sur Num</u>	<u>Suff</u>	<u>Subdivision</u>	<u>Act Pend</u>
281001	AUTHORIZED	14	0290N	0180W	026	MNR	1	E2E2E2;	

Serial Number: AZA 032166

Total Case Acres: 5.100

<u>Casetype</u>	<u>Case Disp</u>			<u>Sect</u>	<u>Sur Typ</u>	<u>Sur Num</u>	<u>Suff</u>	<u>Subdivision</u>	<u>Act Pend</u>
281001	AUTHORIZED	14	0290N	0180W	026	FF		S 42';	

PARTIALLY SURVEYED TOWNSHIP 29 NORTH RANGE 18 WEST OF THE GILA AND SALT RIVER MERIDIAN, ARIZONA

STATUS OF PUBLIC DOMAIN
LAND AND MINERAL TITLES

MOHAVE COUNTY

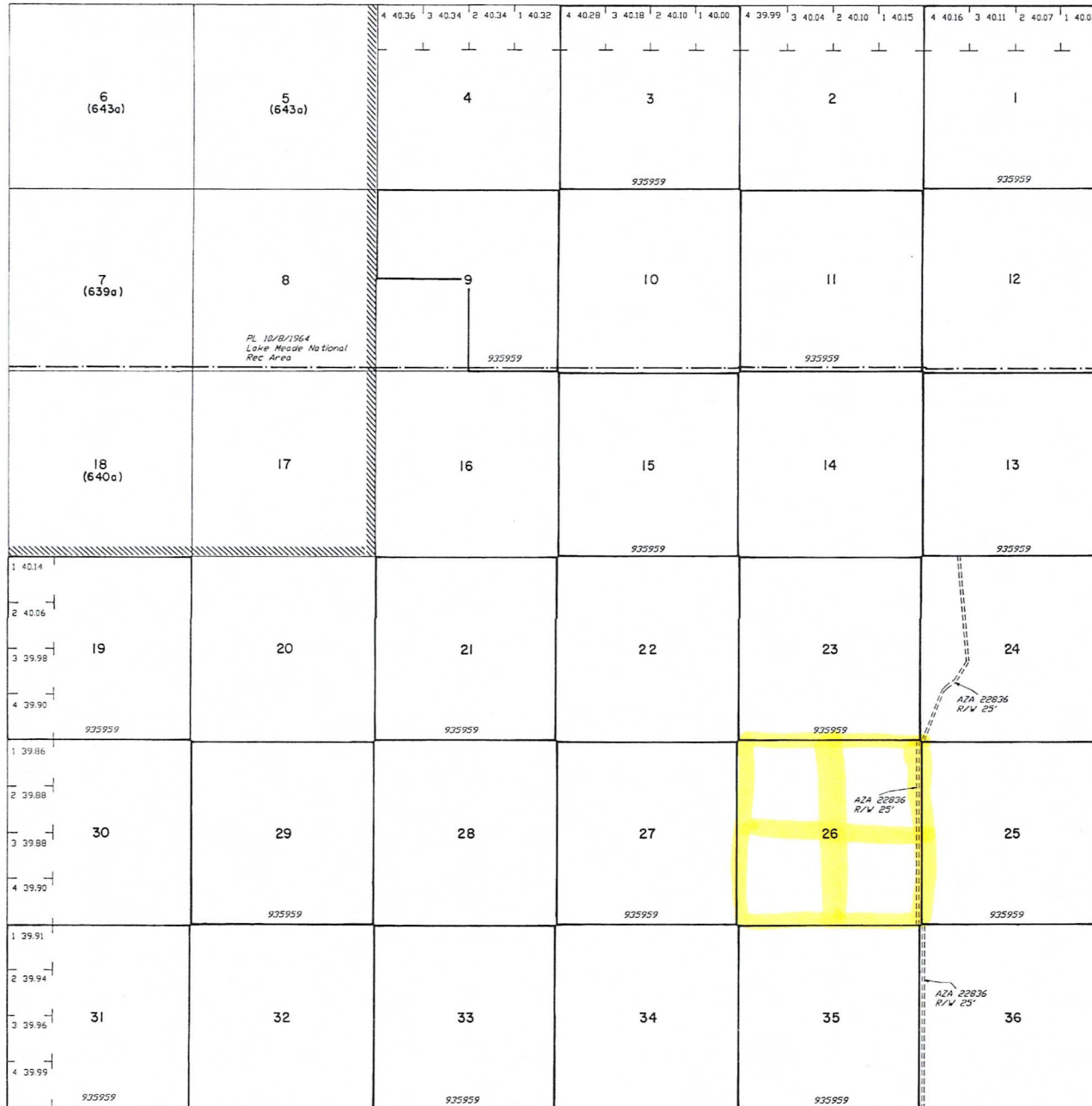

INDEX TO SEGREGATED TRACTS

RESURVEY	ORIGINAL SURVEY		
TRACT NO	T	R	SUBDIVISION

FOR ORDERS EFFECTING DISPOSAL OR USE OF UNIDENTIFIED LANDS WITHDRAWN FOR CLASSIFICATION, MINERALS, WATER AND/OR OTHER PUBLIC PURPOSES, REFER TO INDEX OF MISCELLANEOUS DOCUMENTS.

- DIST. NO. 2
- GRAZING DIST. NO. 2
- PROTRACTION DIAGRAM NO. 6
- All lands within 6 miles of Colo. River W. of 114 Mer. Included in Temp. W.R. Colo. River Survey SO 1/31/1903
- PLO 5048 REV W.R. SO 1/31/1903 SEE H.I. Sec 1-6

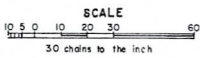

Lot 35°50'57" N
Long. 114°10'10" W

WARNING STATEMENT
This plat is the Bureau's Record of Title, and should be used only as a graphic display of the township survey data. Records hereon do not reflect title changes, which may have been effected by lateral movements of rivers or other bodies of water. Refer to the cadastral surveys for official survey information.

CURRENT TO	BY
5/28/1998	JB

T. 29N
R. 18 W